

KNOXHULT

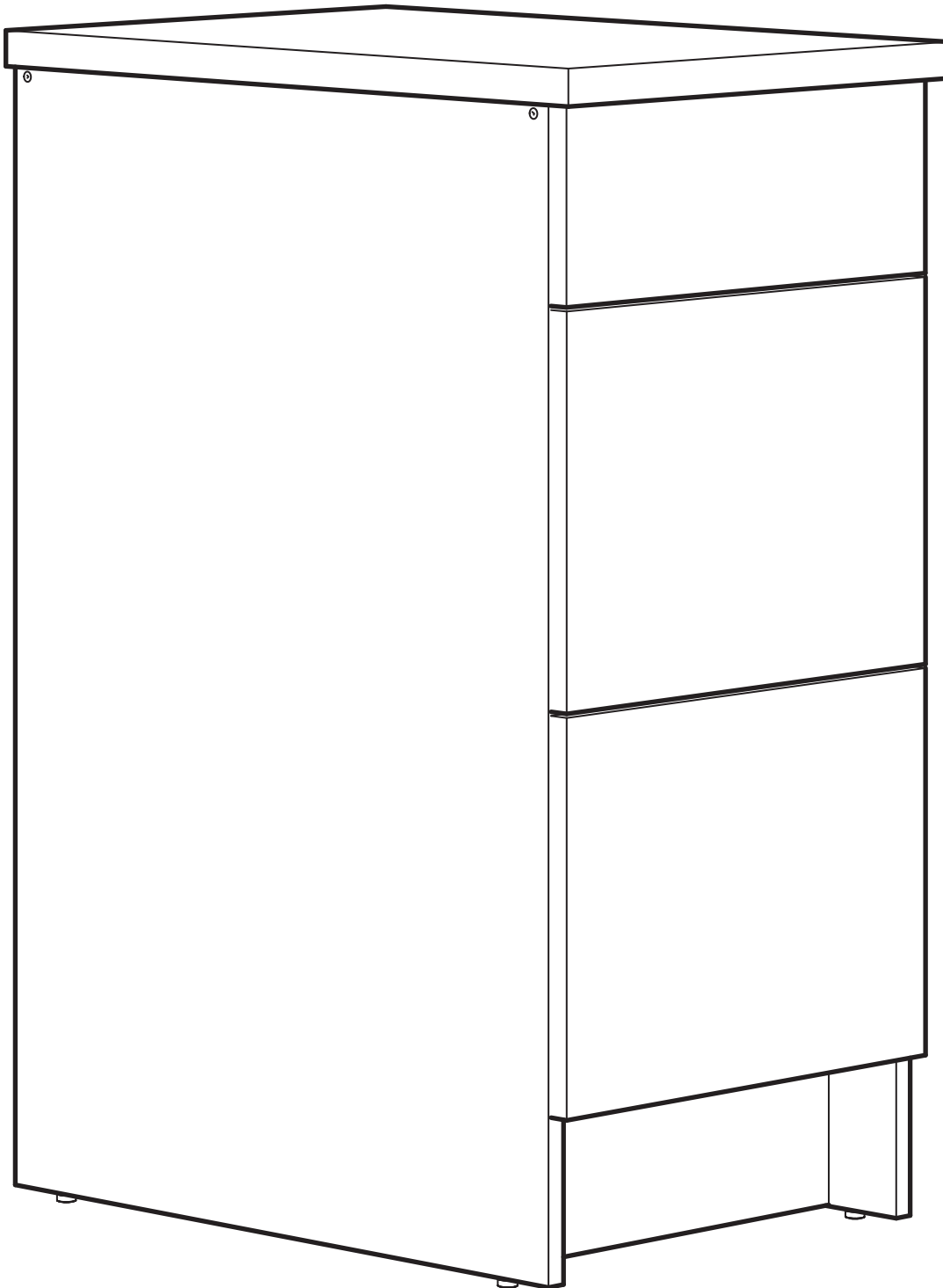

Design and Quality
IKEA of Sweden



РУССКИЙ

Важная информация

Внимательно прочитайте.

Необходимо тщательно следовать всем рекомендациям.

Сохраните эту информацию для справок в дальнейшем.

ВНИМАНИЕ!

Опрокидывание мебели может стать причиной получения серьезных травм или даже привести к смерти. Чтобы предотвратить опрокидывание, необходимо обеспечить стационарное крепление мебели к стене с помощью прилагающихся крепежных аксессуаров.

Материалы стен различаются, поэтому крепежные средства не прилагаются. Используйте крепежные средства, подходящие для материала стен в вашем доме. Для выбора подходящих крепежных средств обратитесь в специализированный магазин.

ENGLISH

Important information

Read carefully

Follow each step of the instruction carefully

Keep this information for further reference

WARNING

Serious or fatal crushing injuries can occur from furniture tip-over. To prevent this furniture from tipping over it must be permanently fixed to the wall with the included wall attachment devices.

Fastening devices for the wall are not included since different wall materials require different types of fastening devices. Use fastening devices suitable for the walls in your home. For advice on suitable fastening devices, contact your local specialized dealer.

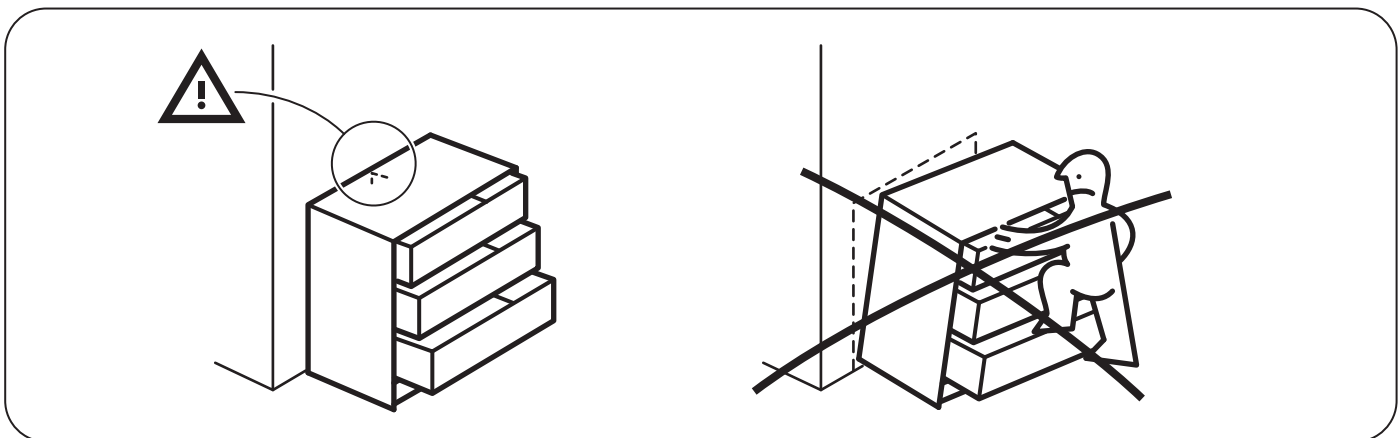
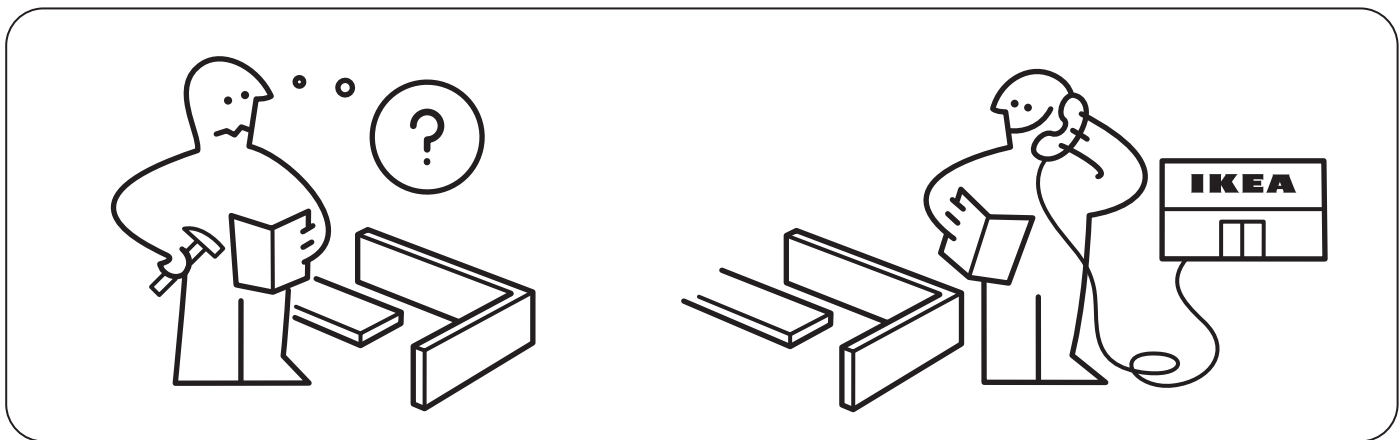
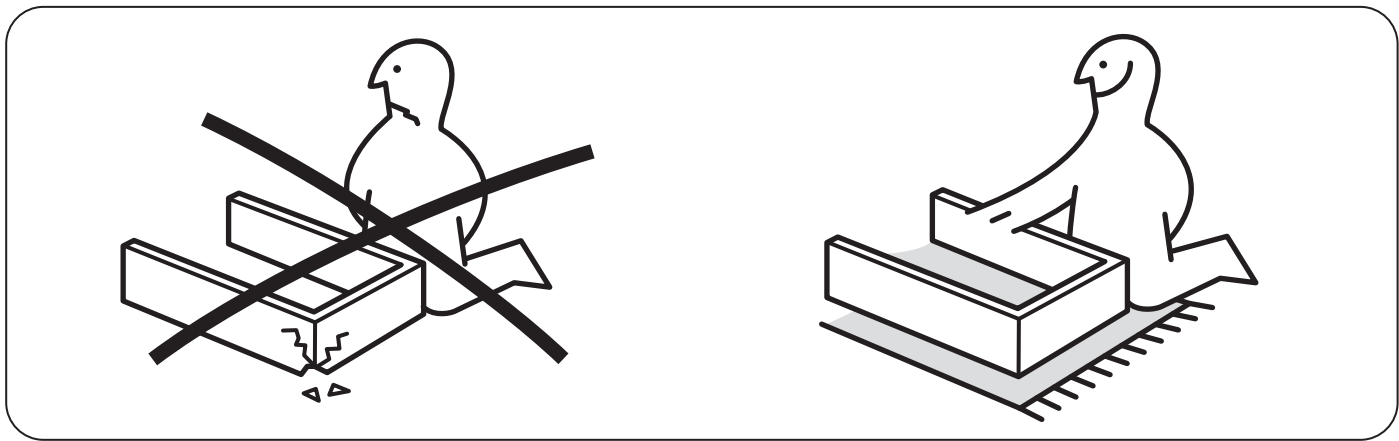
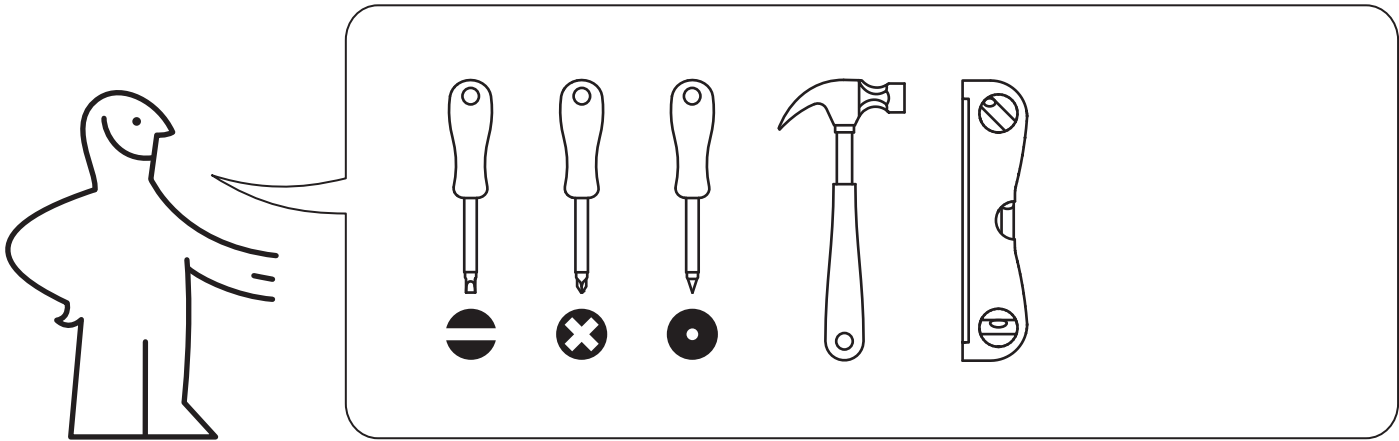

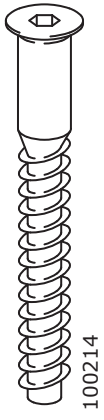

100214

4x



109029

4x



148510

6x



100344

4x



100365

36x



118331

14x

112996

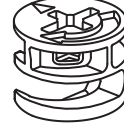

103430

4x



119030

10x

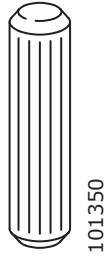

101350

12x

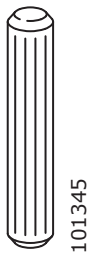

101345

10x

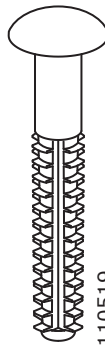

110519

10x

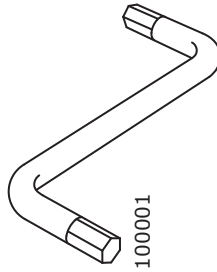

100001

1x



101449

4x

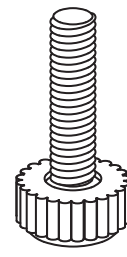

103095

4x

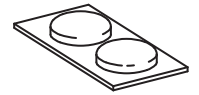

107091

3x

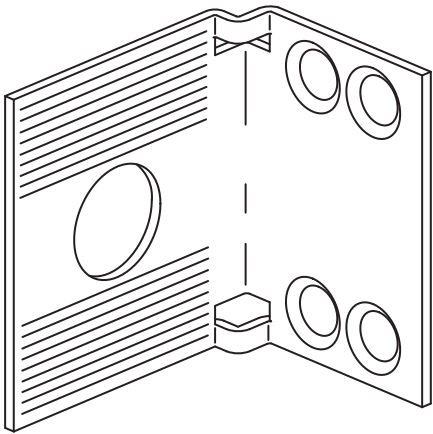

115753

2x

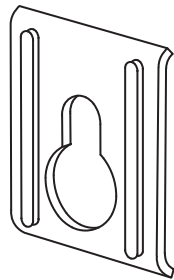

103693

2x

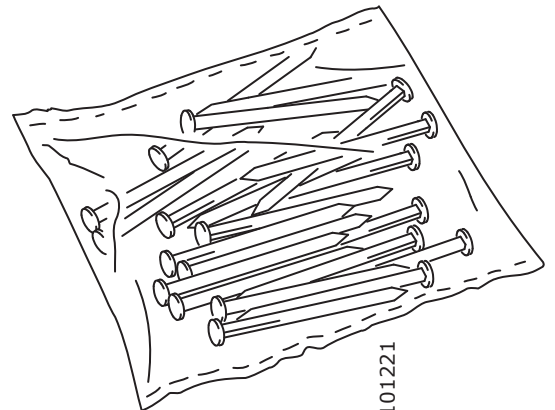

101221

1x

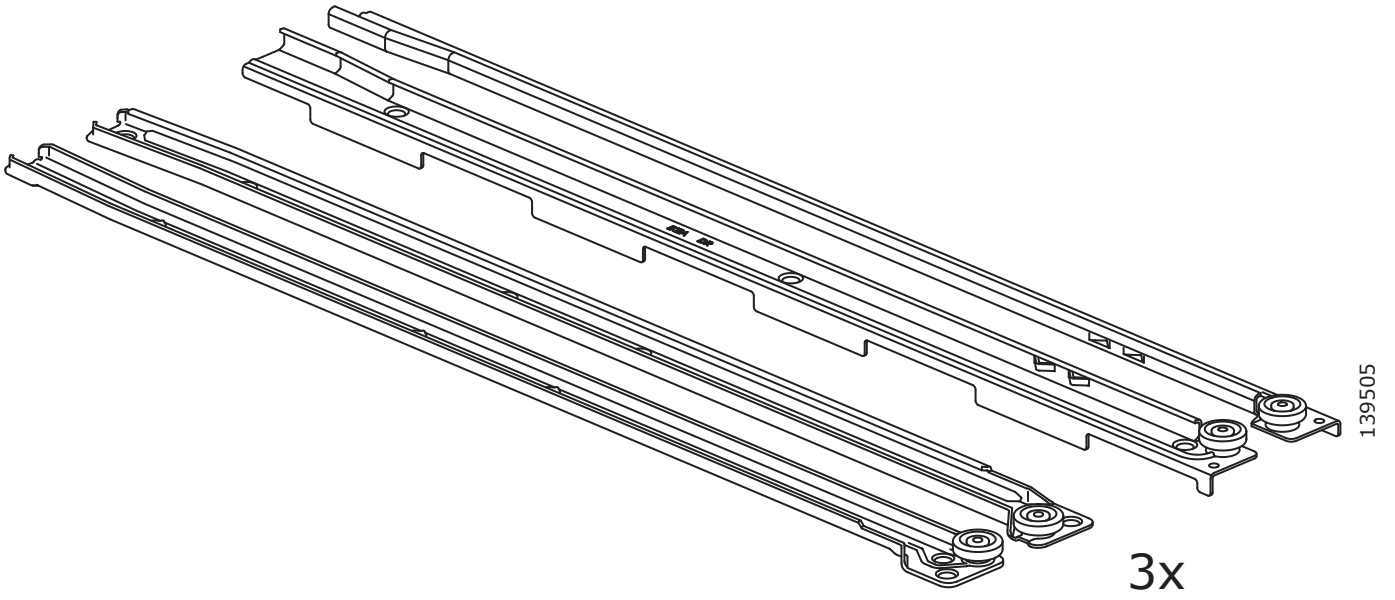

1

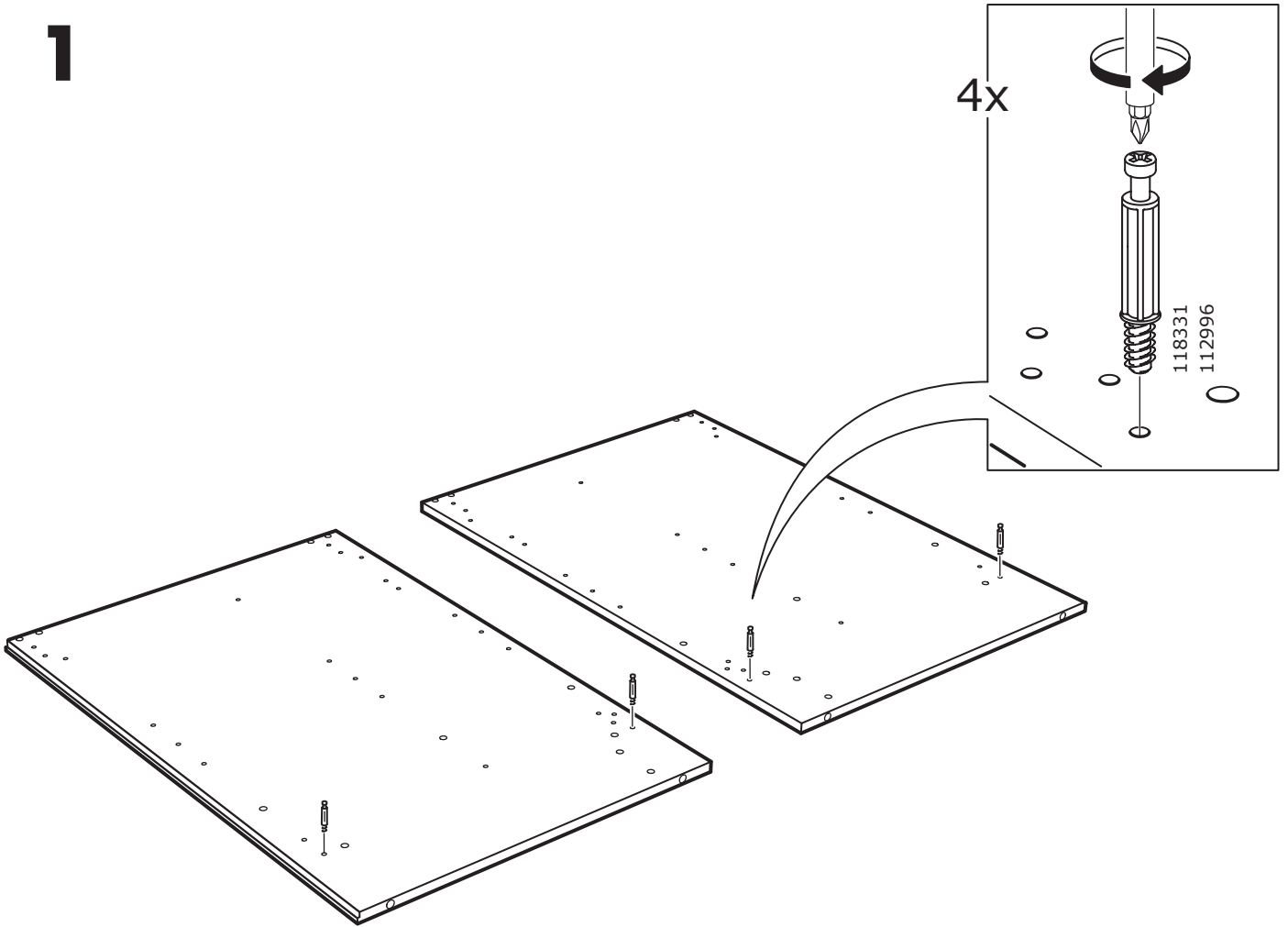

2

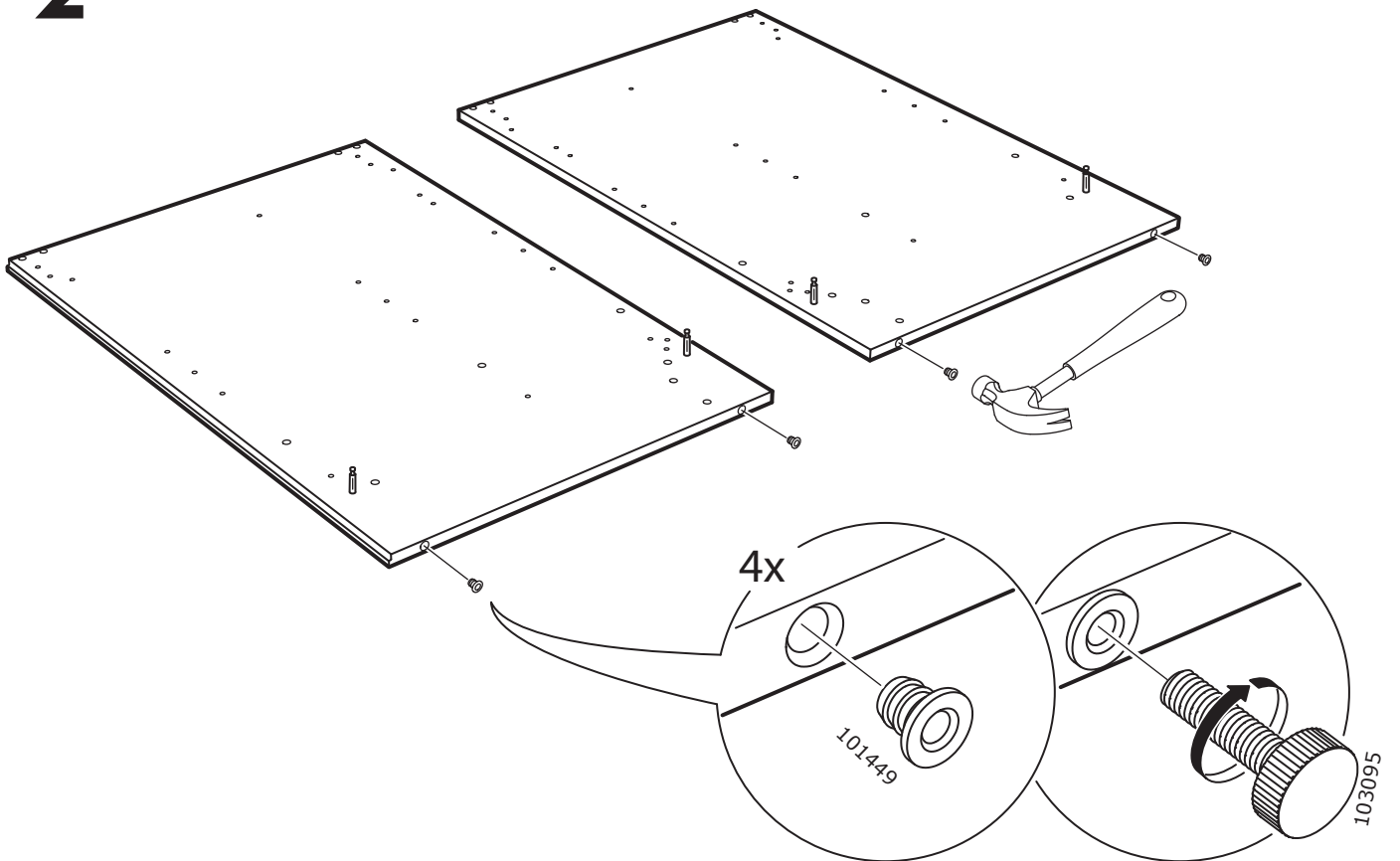

3

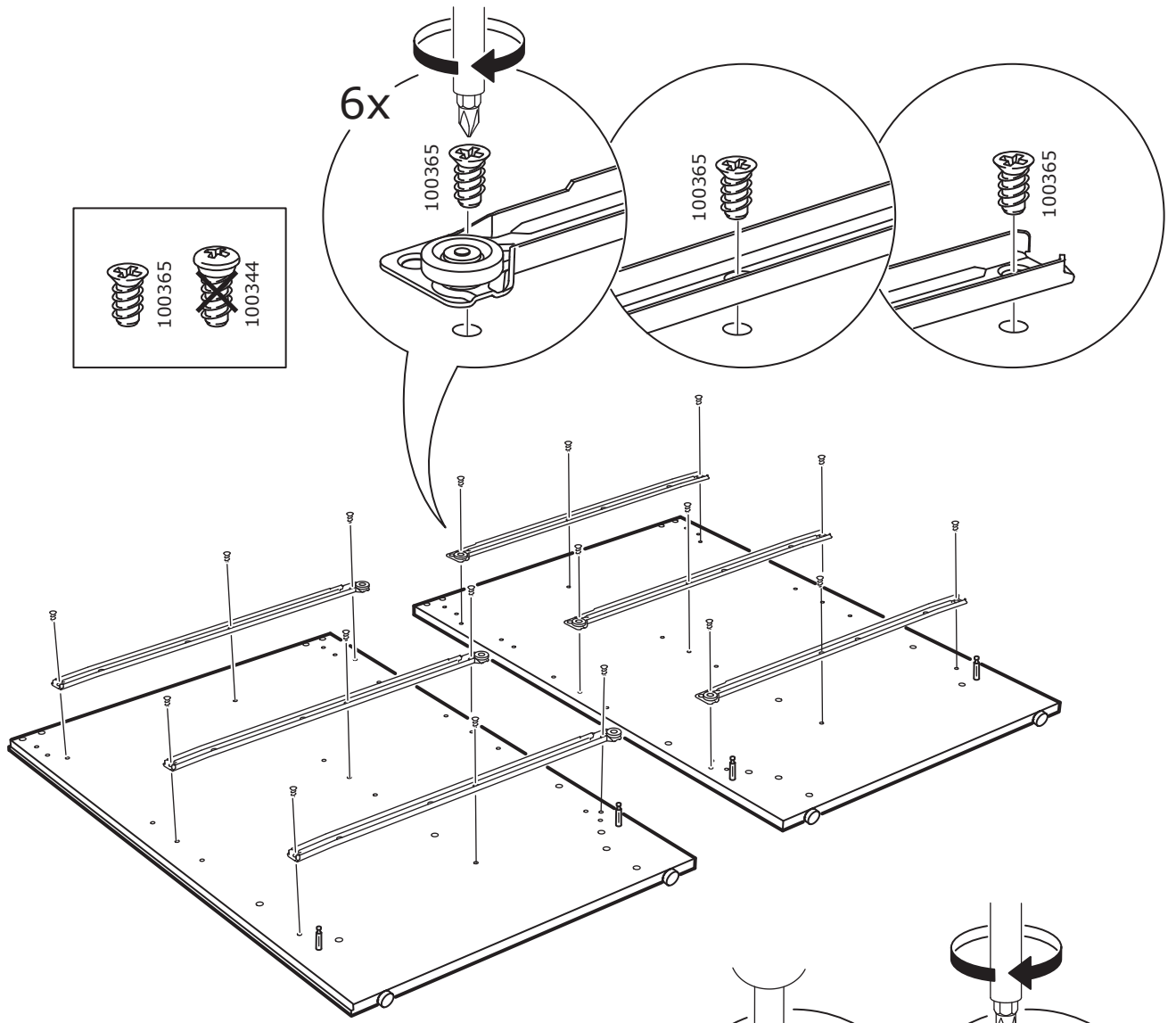

4

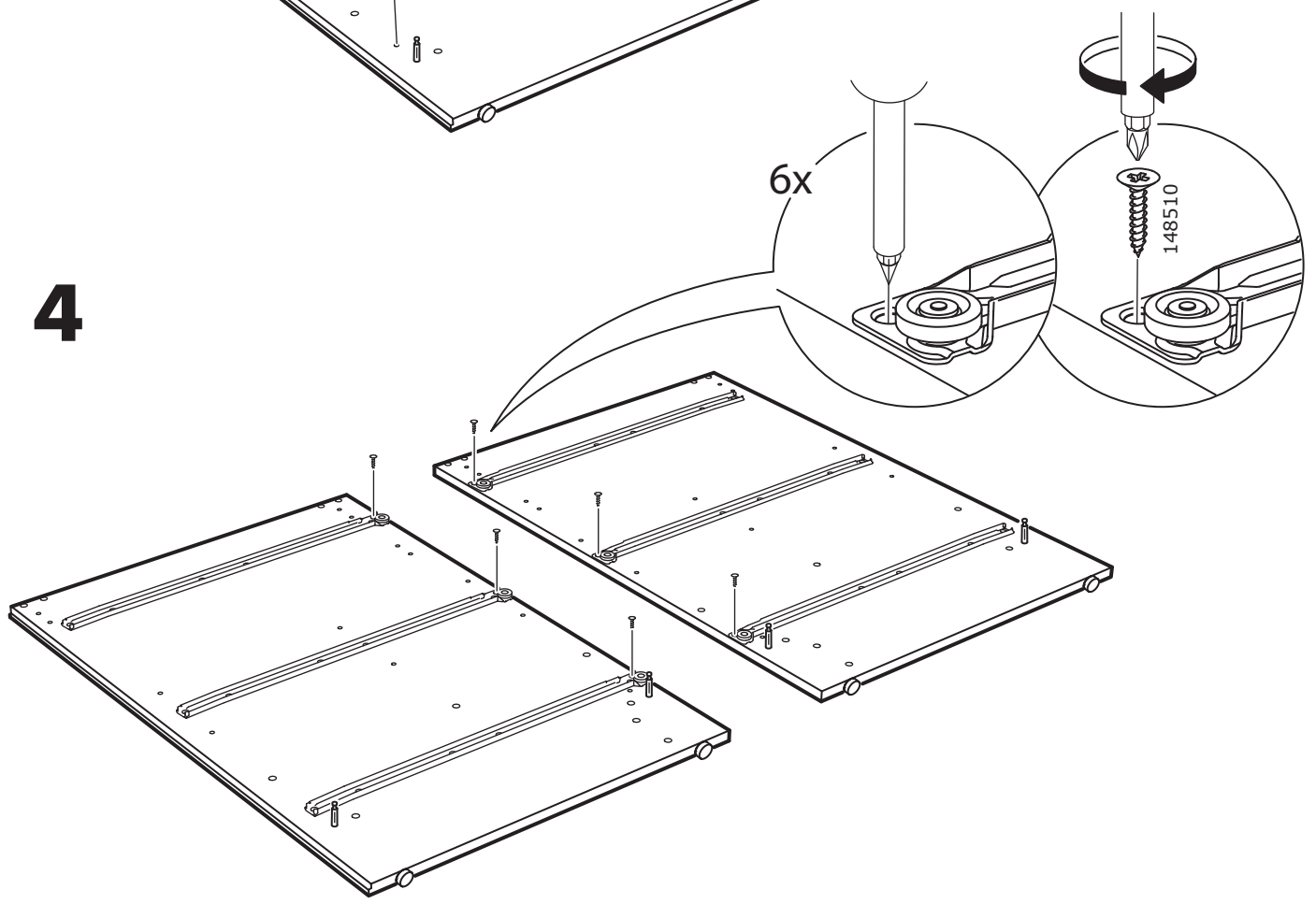

5

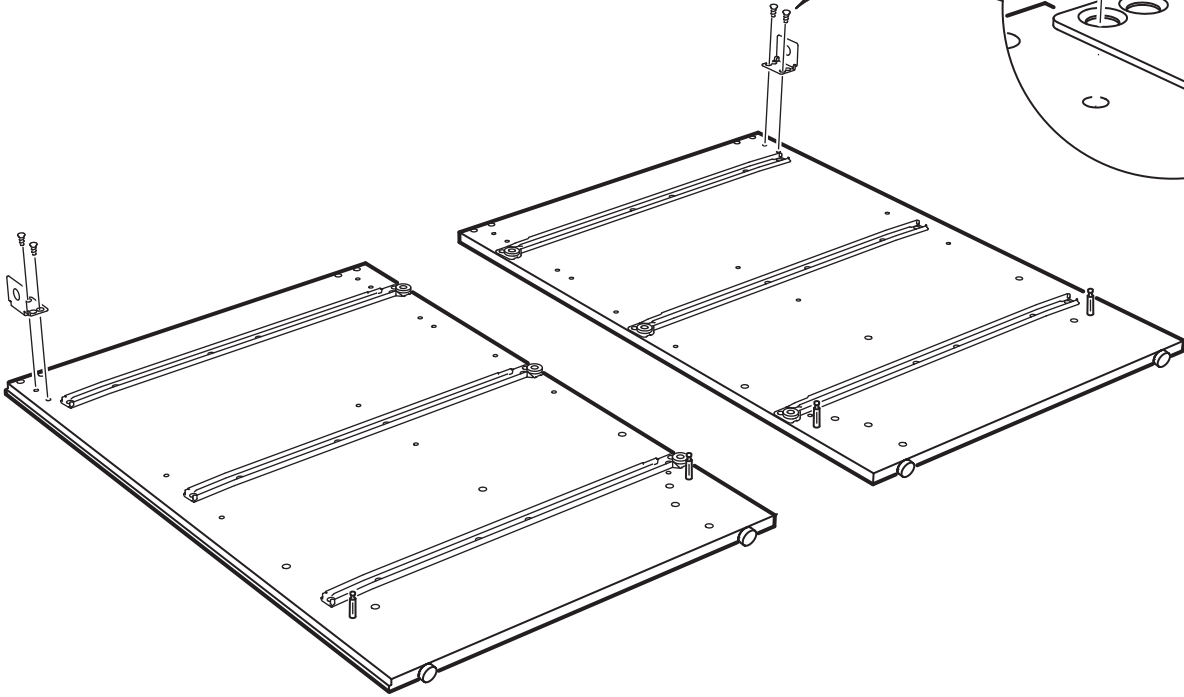
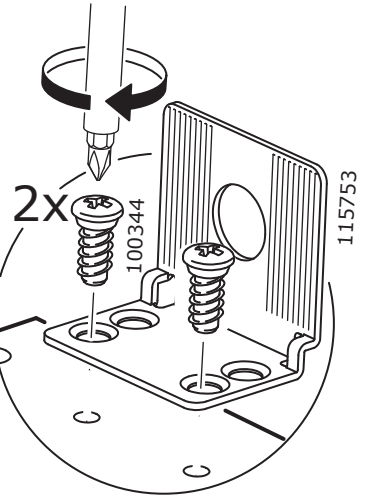
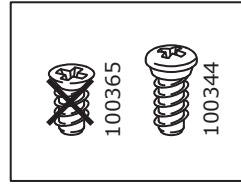

6

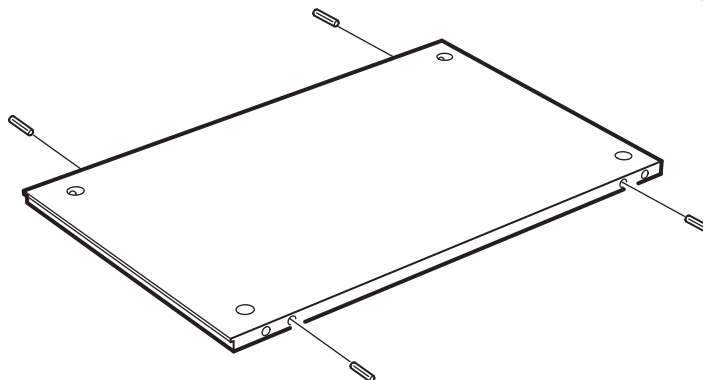
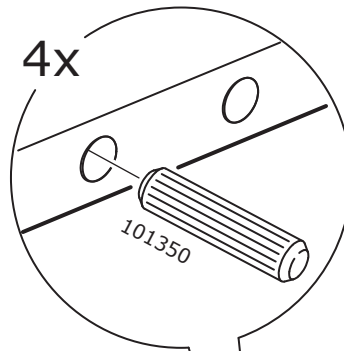
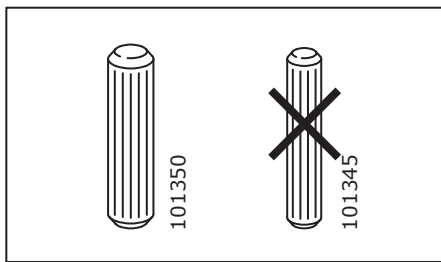

7

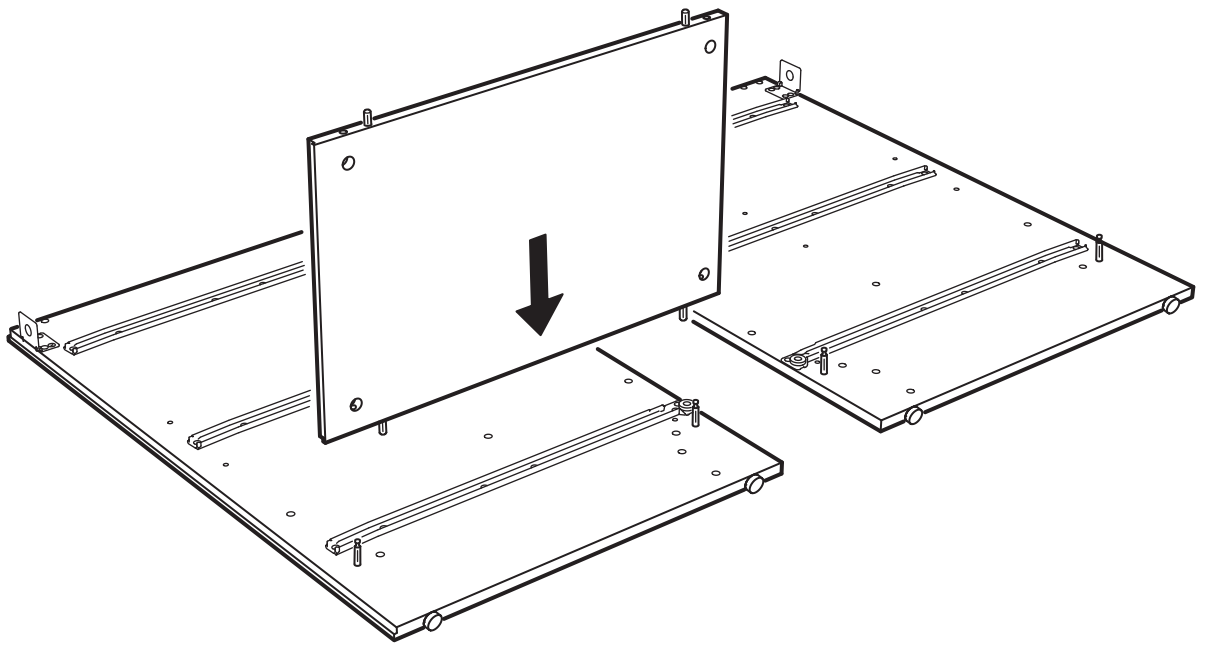

8

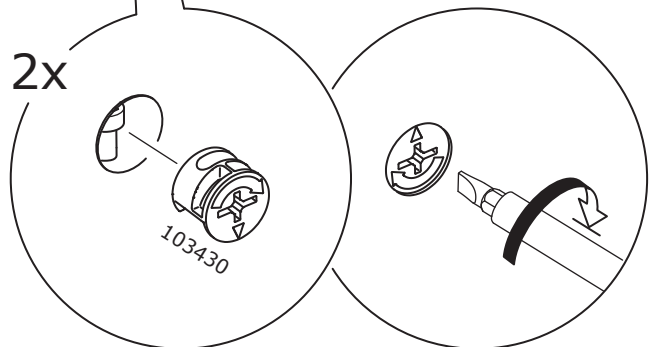
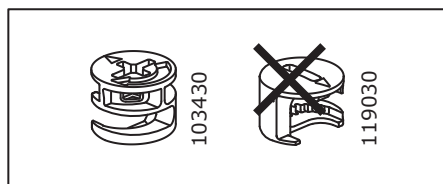
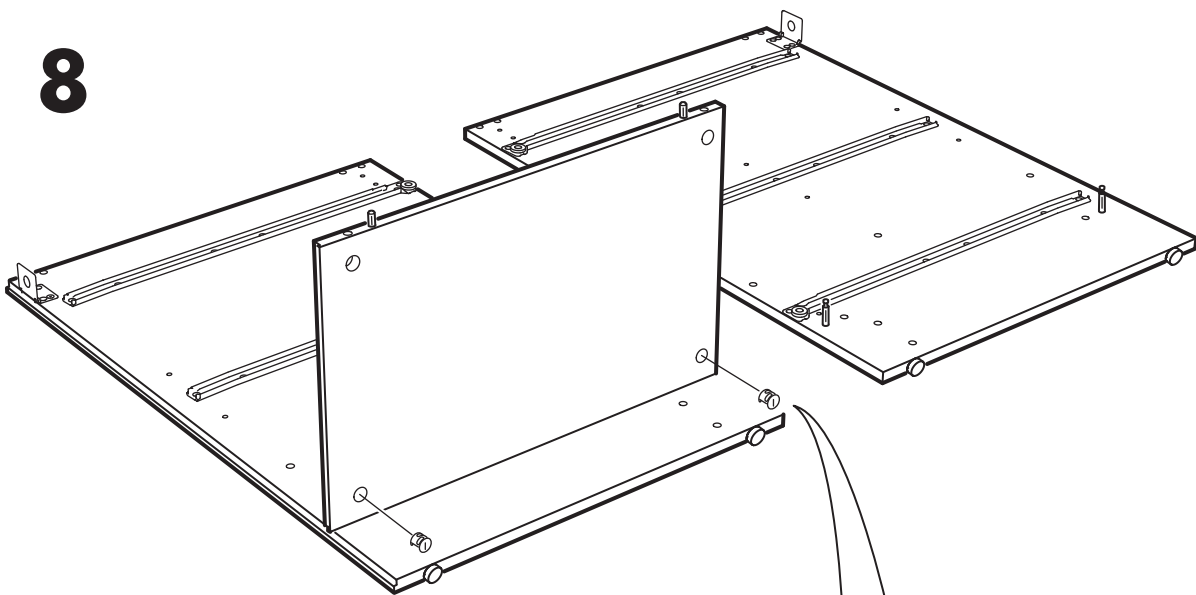

9

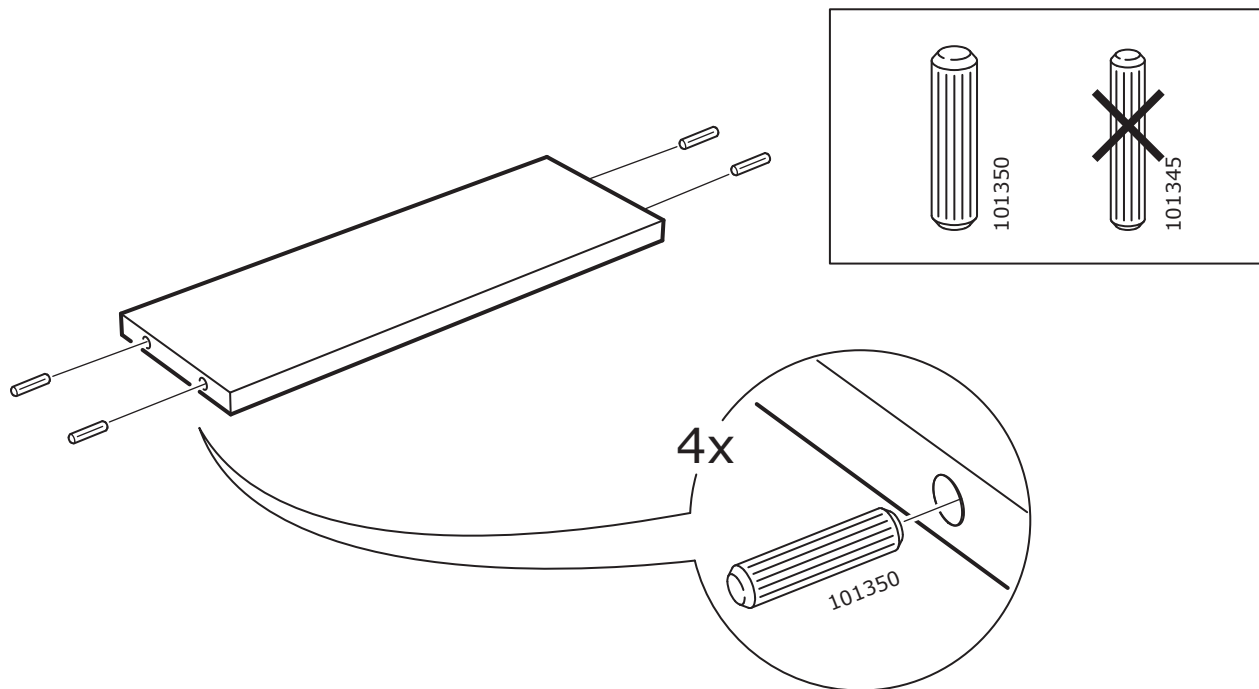

10

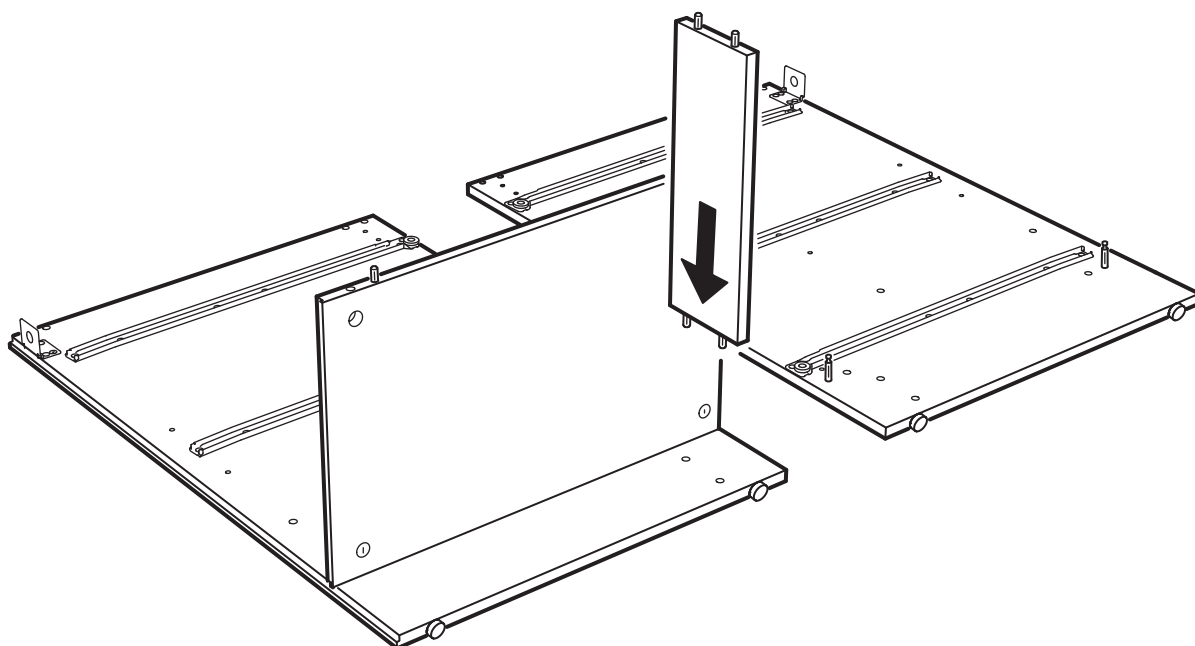

11

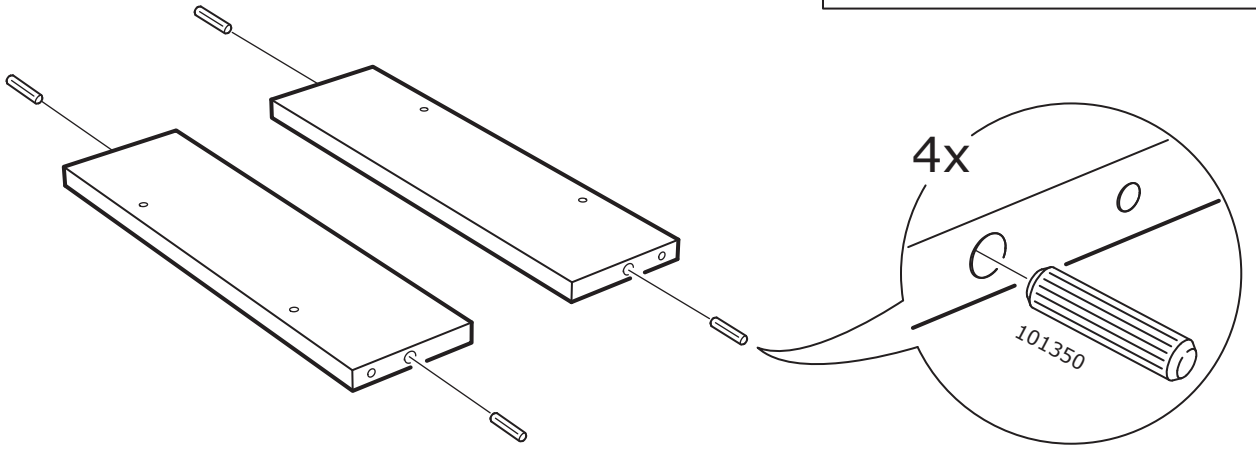
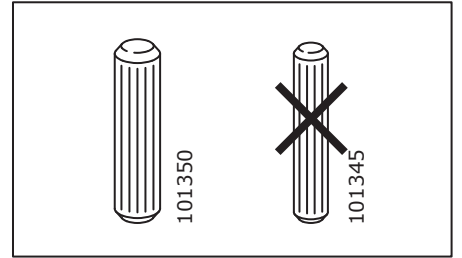

12

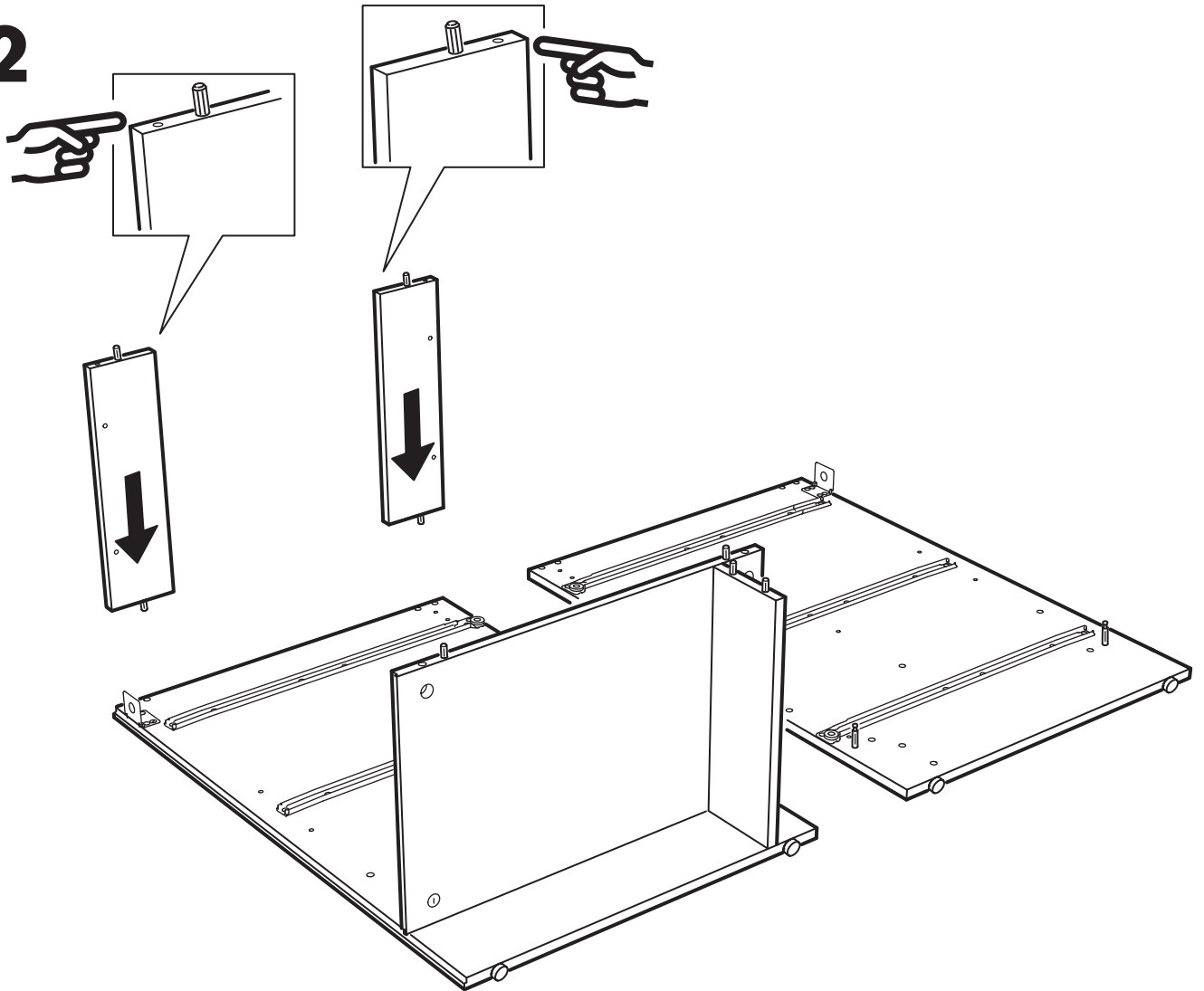

13

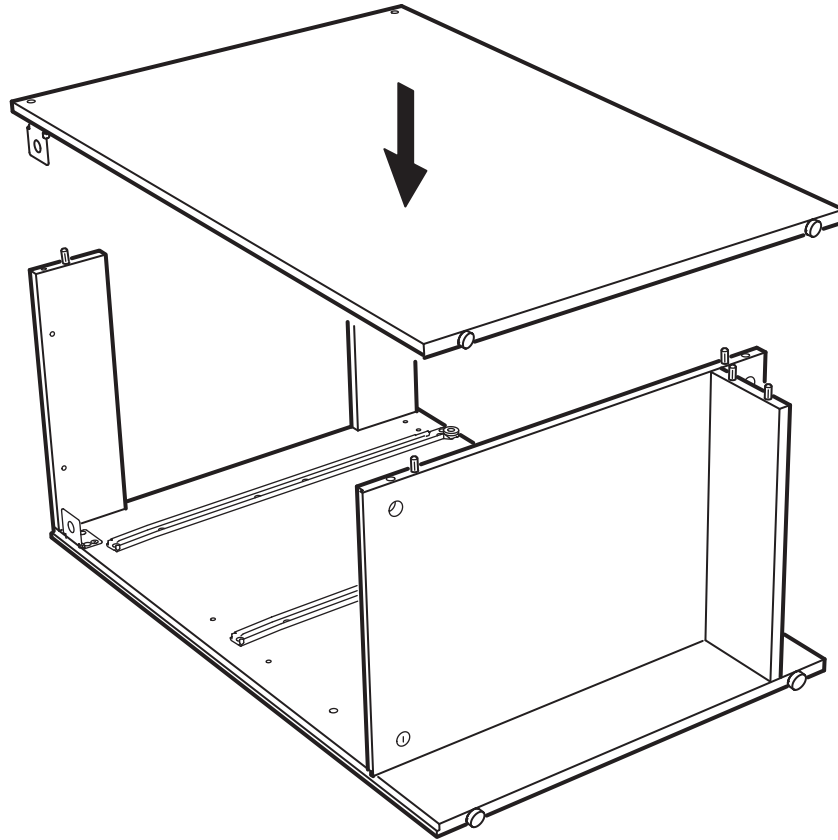

14

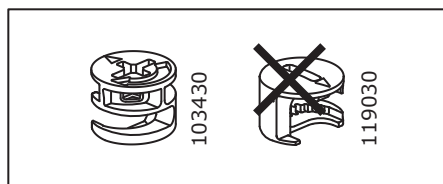
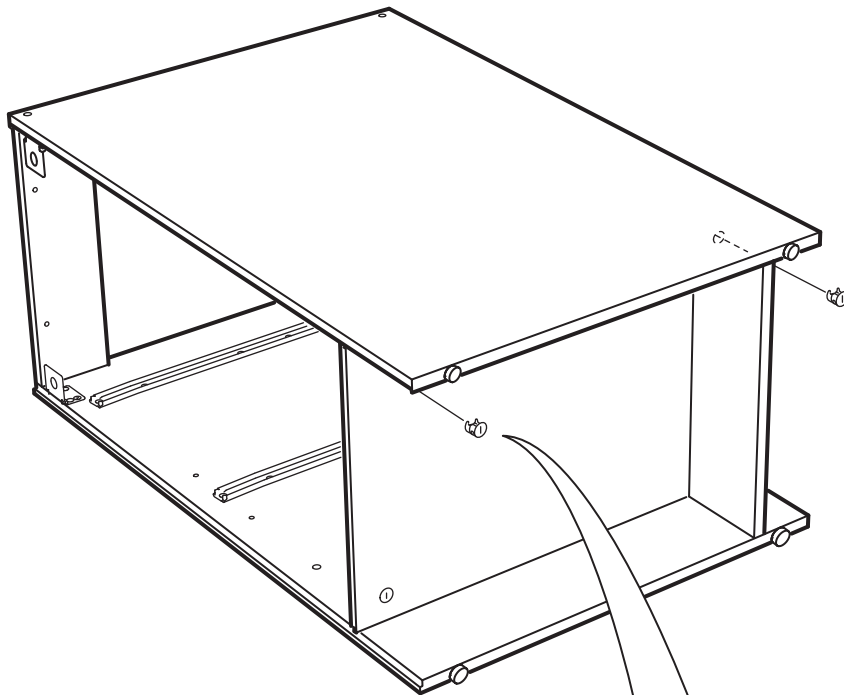

2x

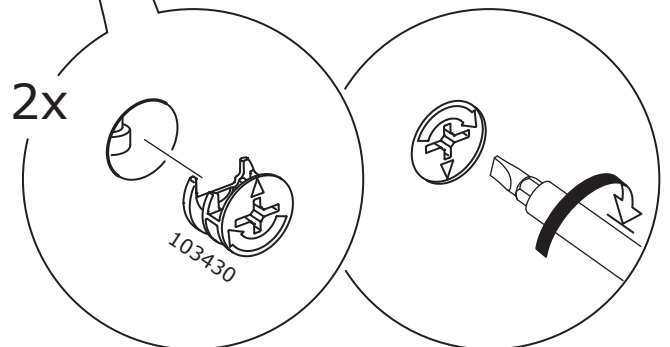

15

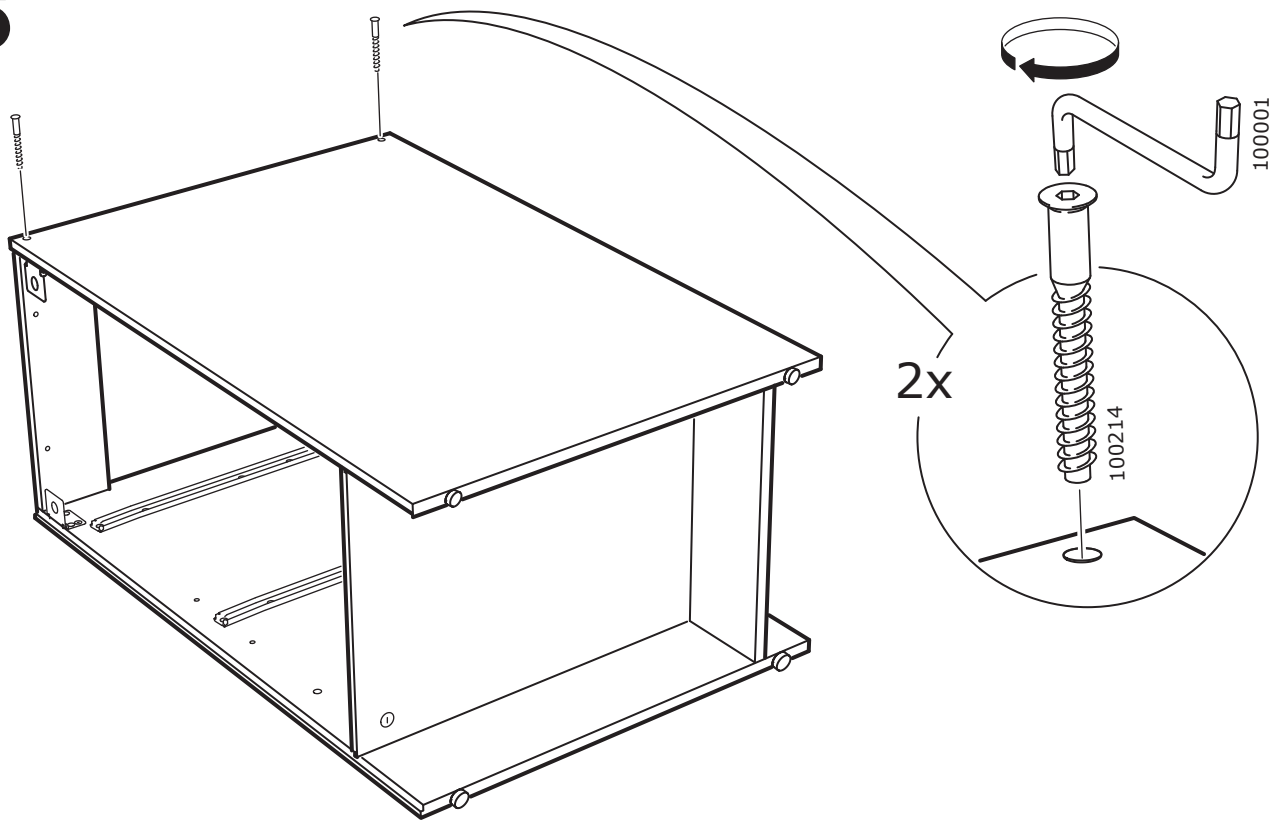

16

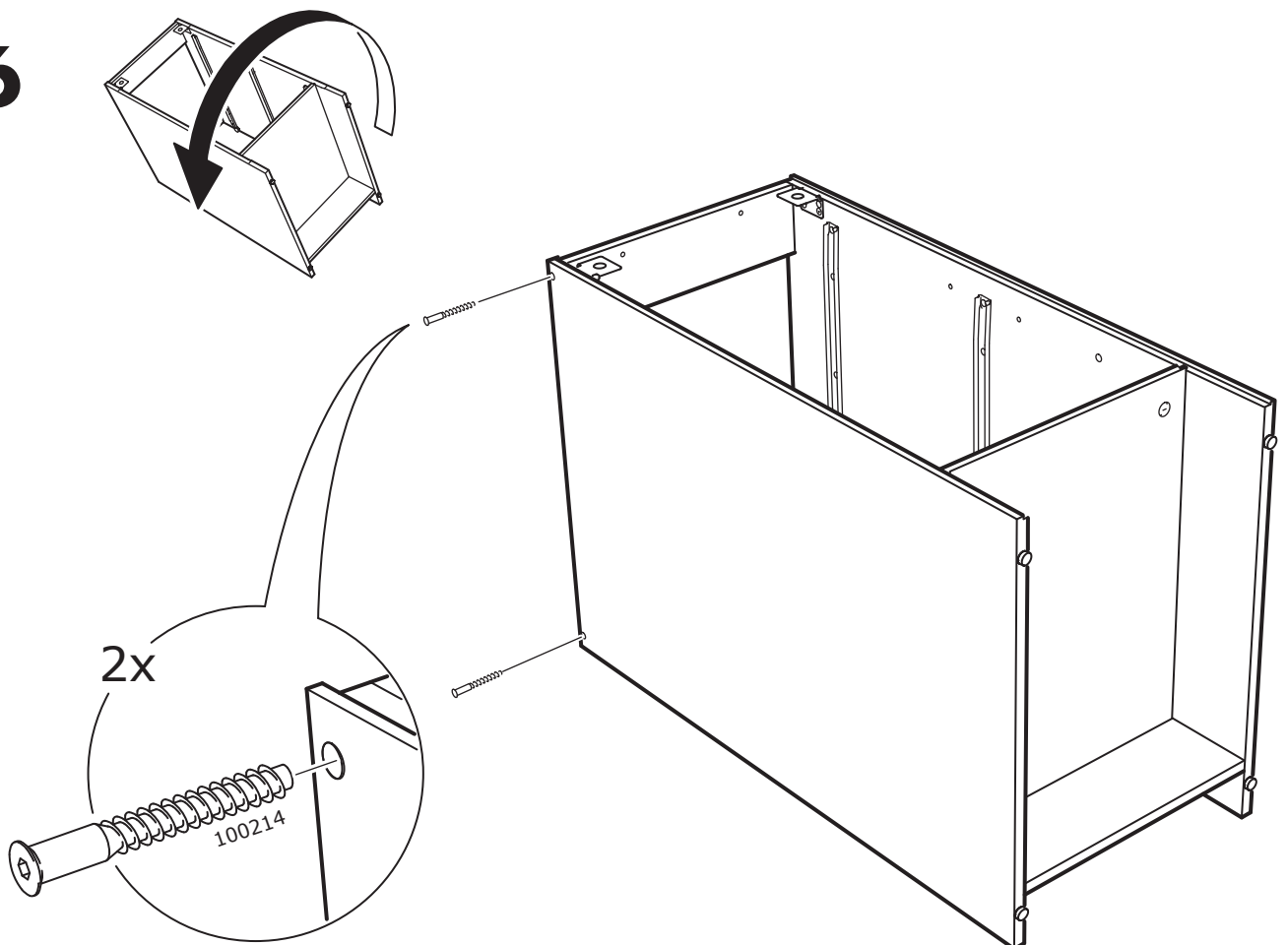

17

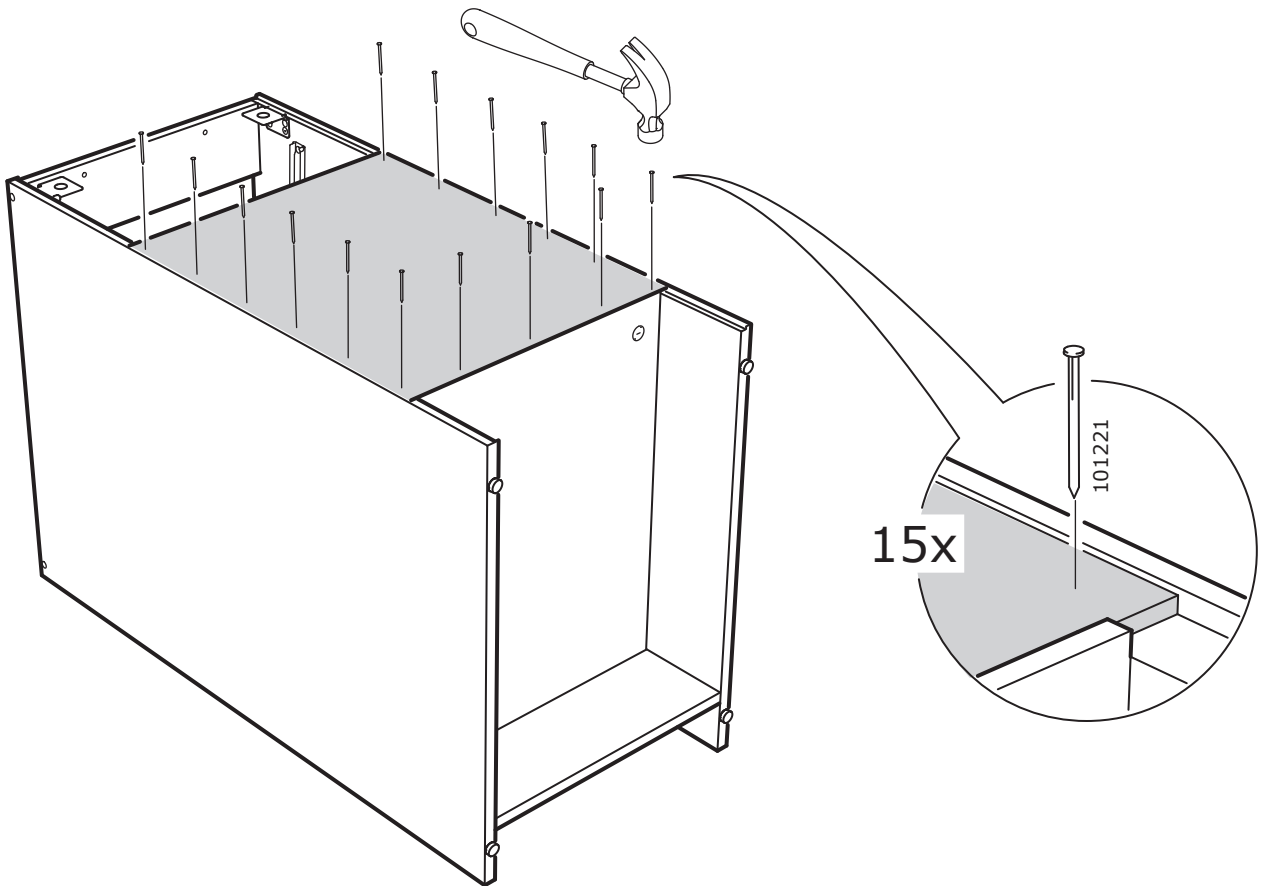
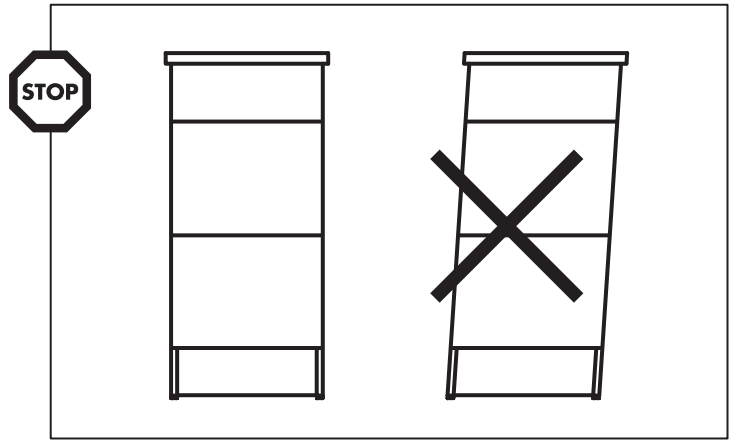
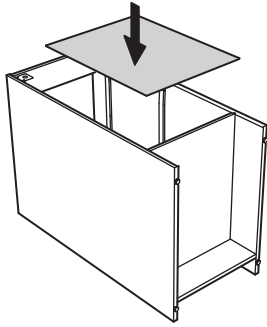

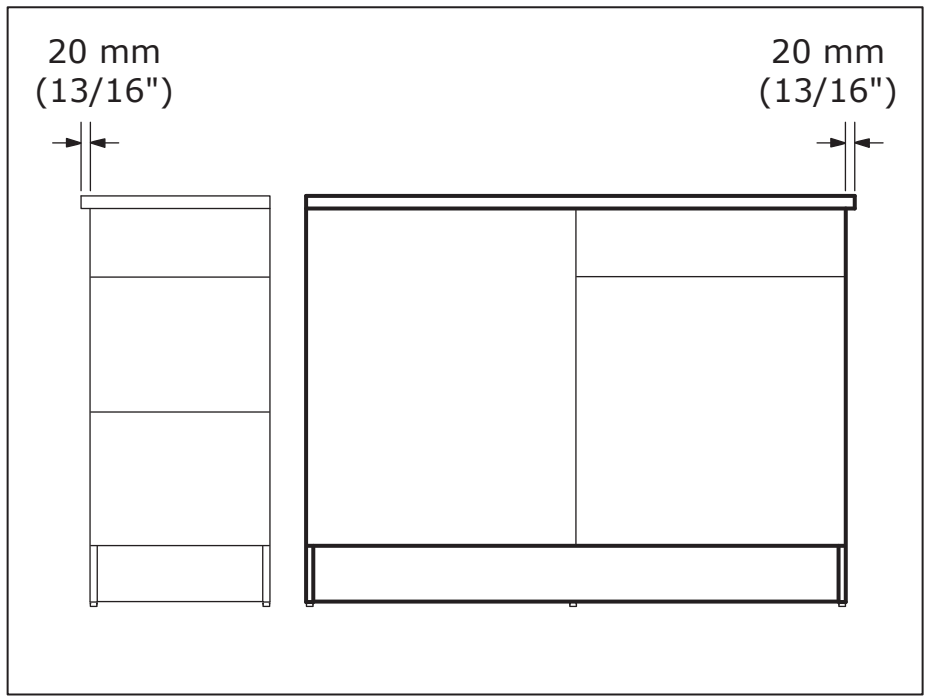
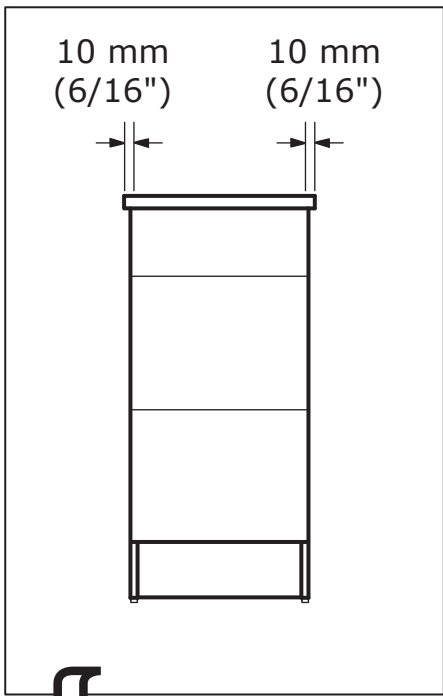

18

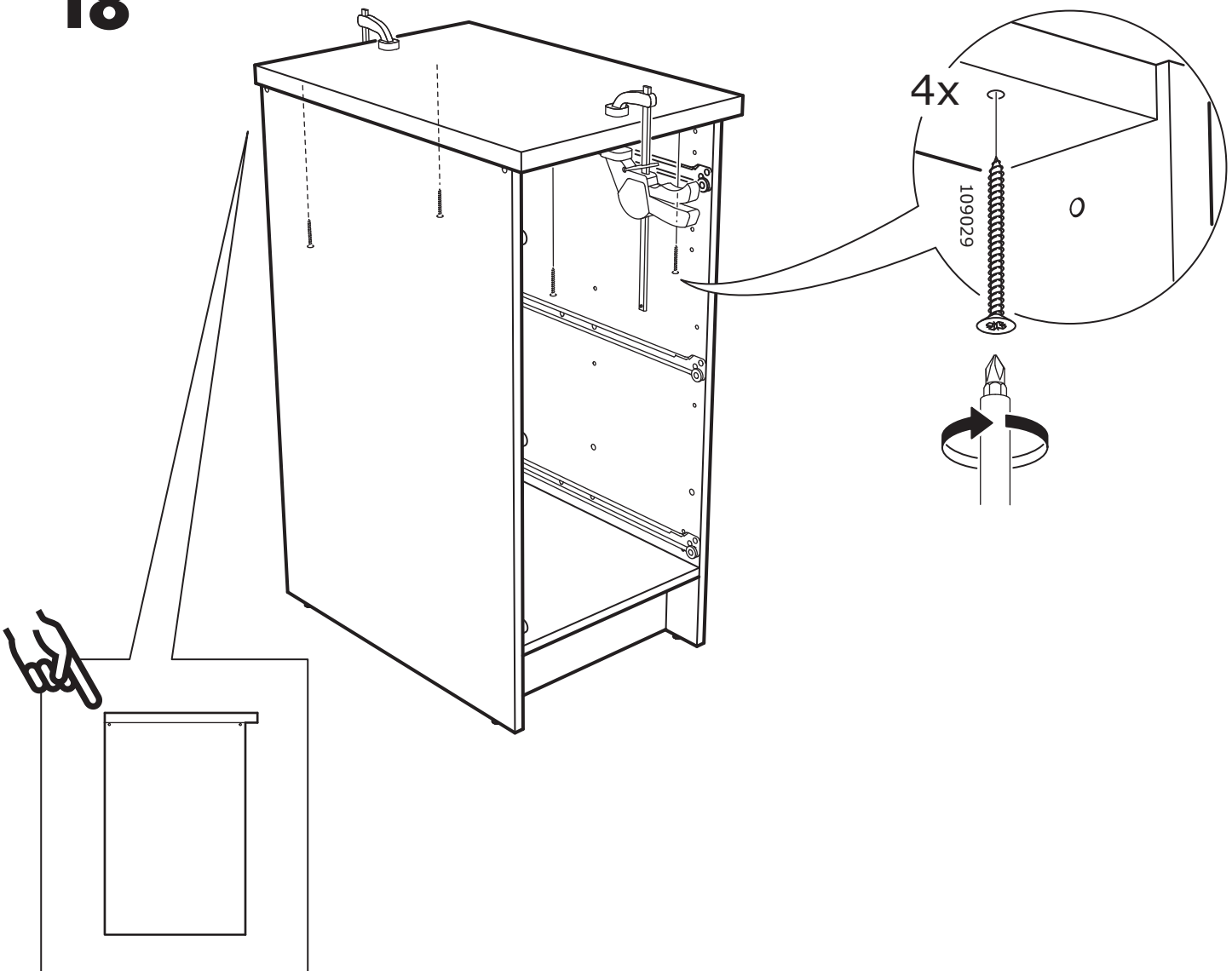

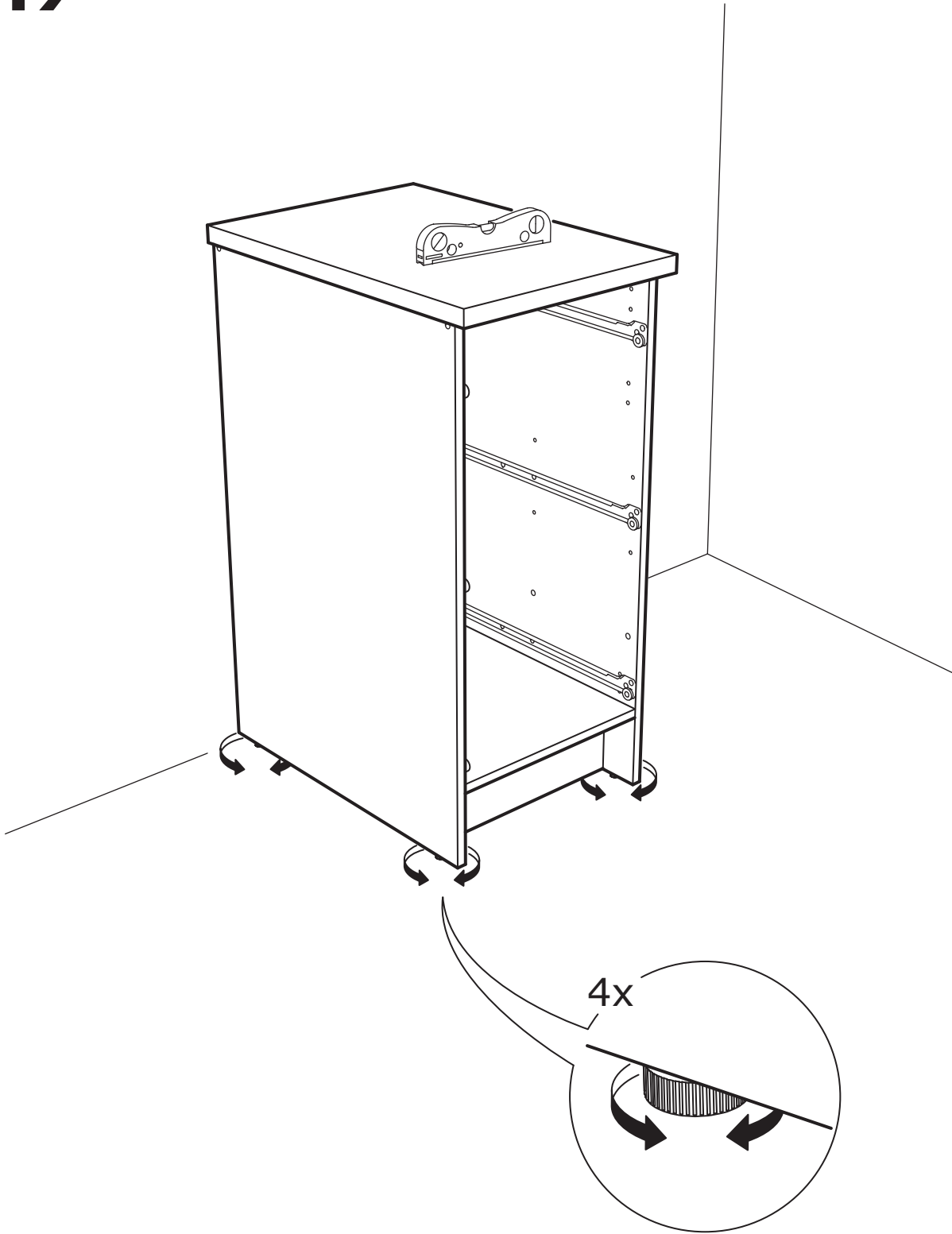

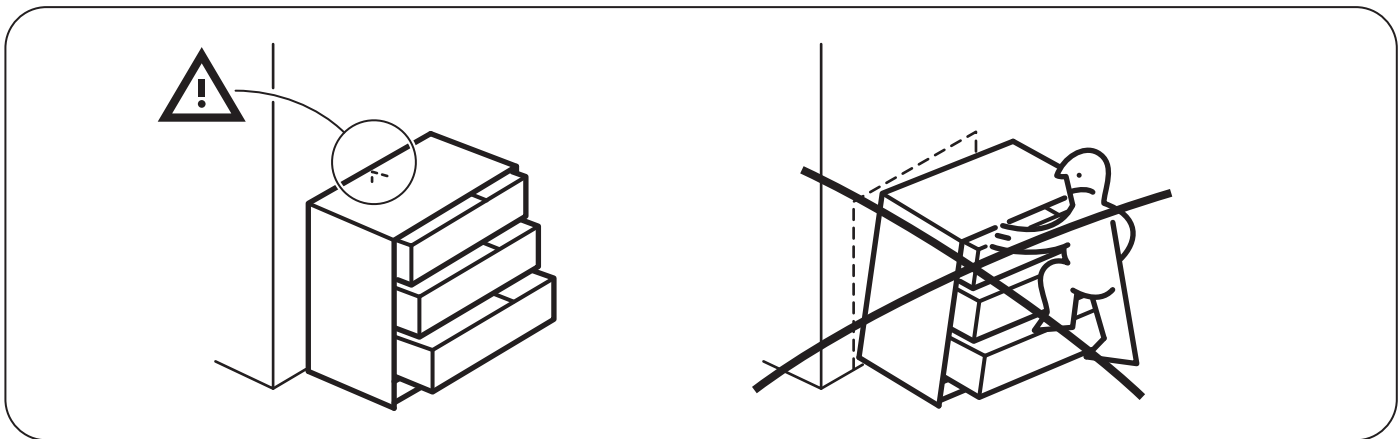

20

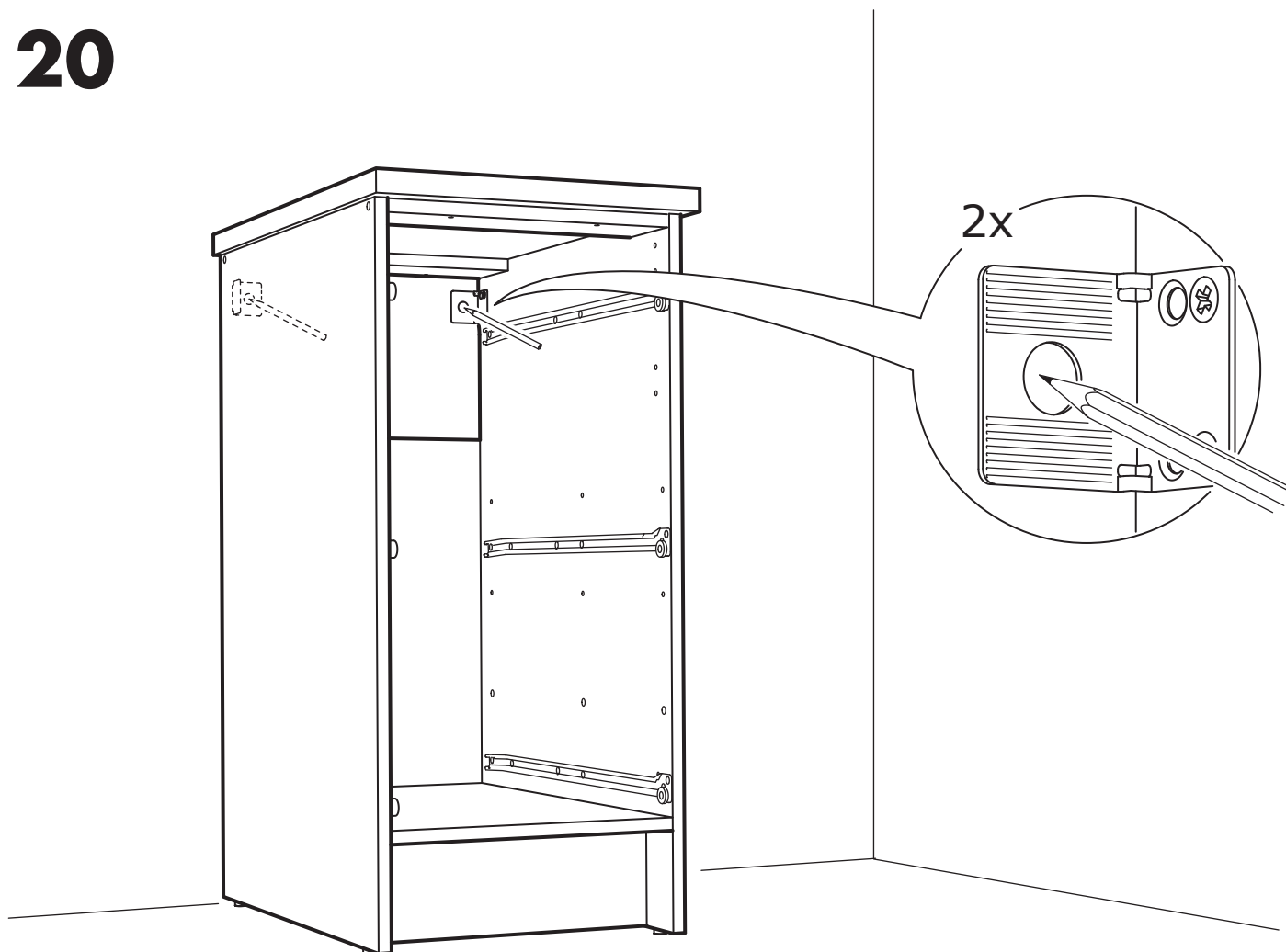

21

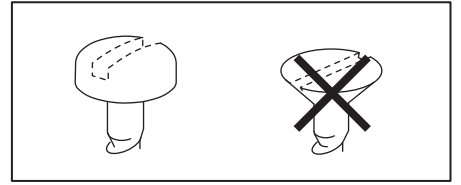

2x

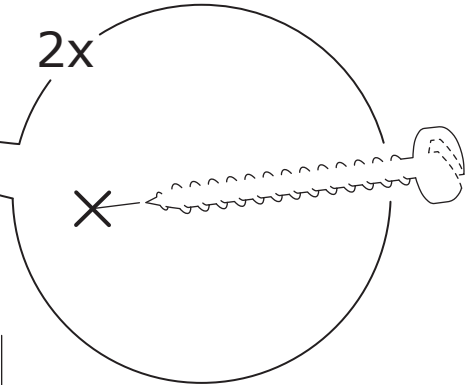

22

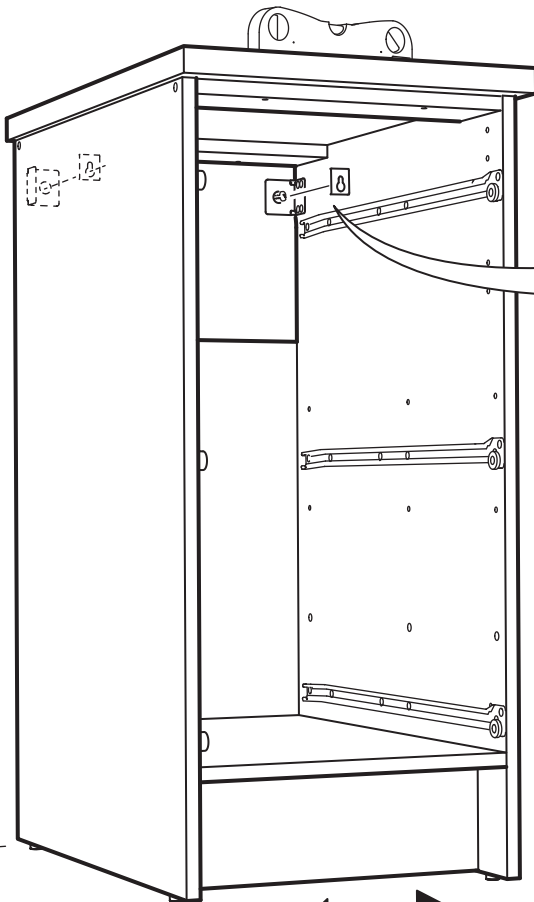

2x

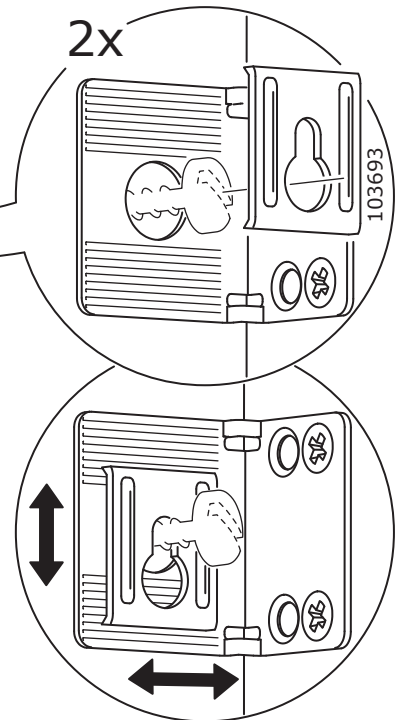

23

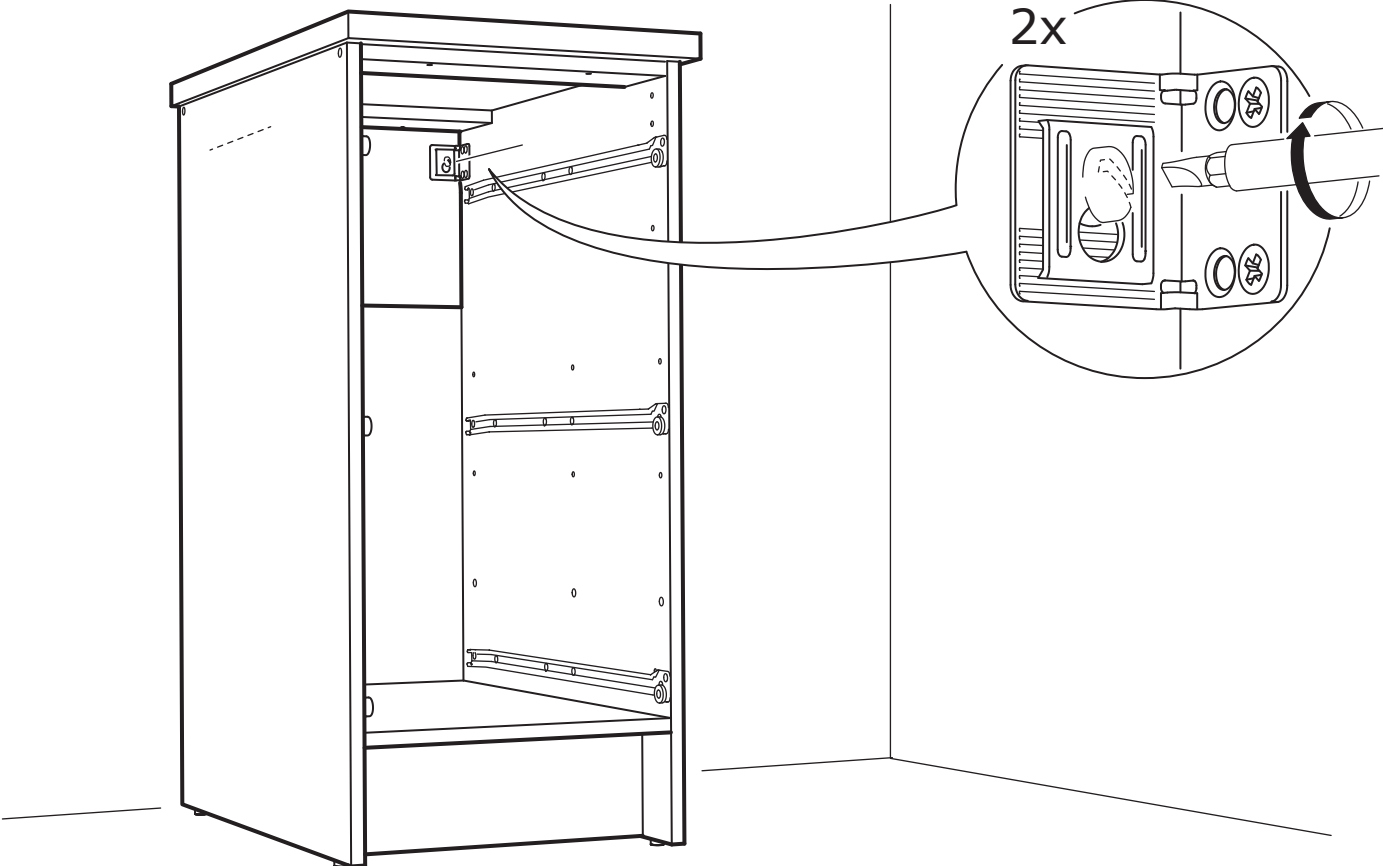

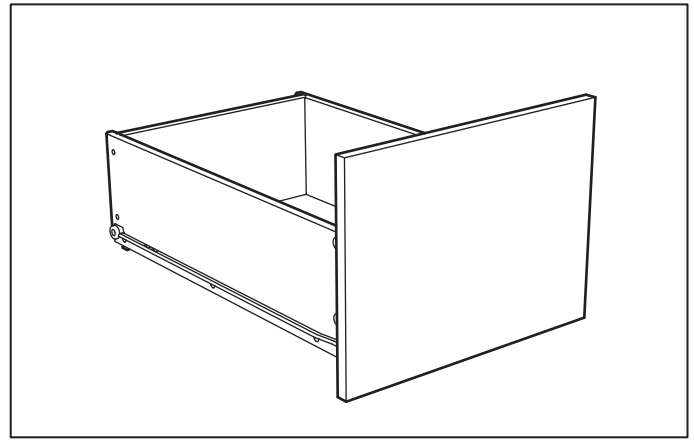
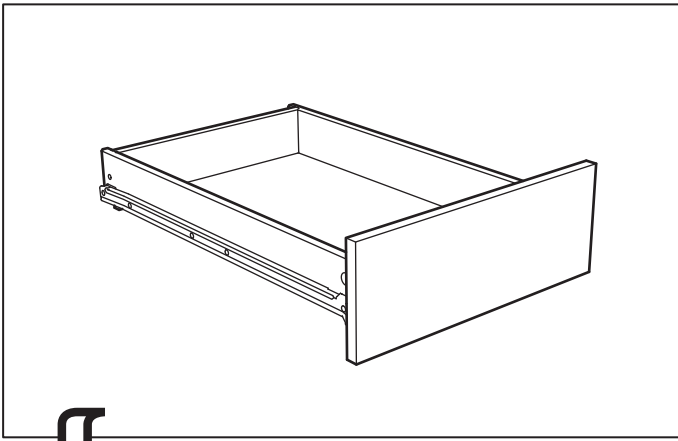

24

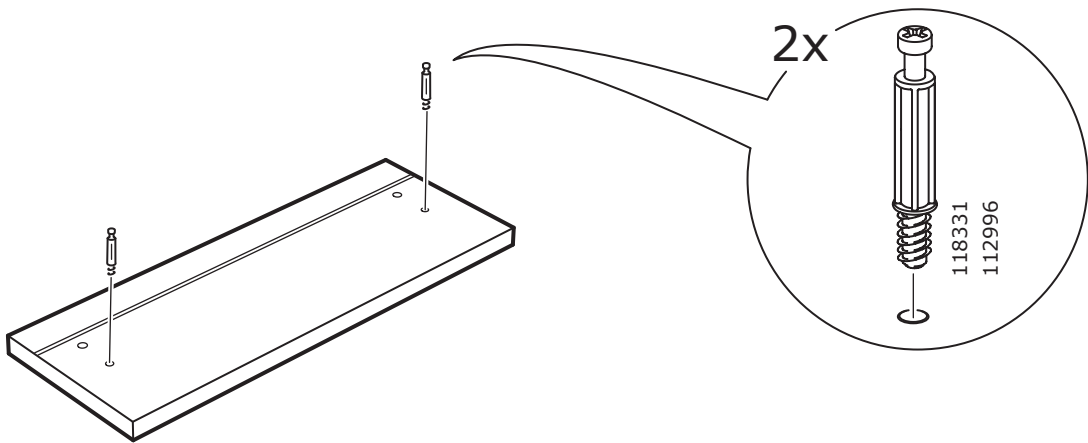

25

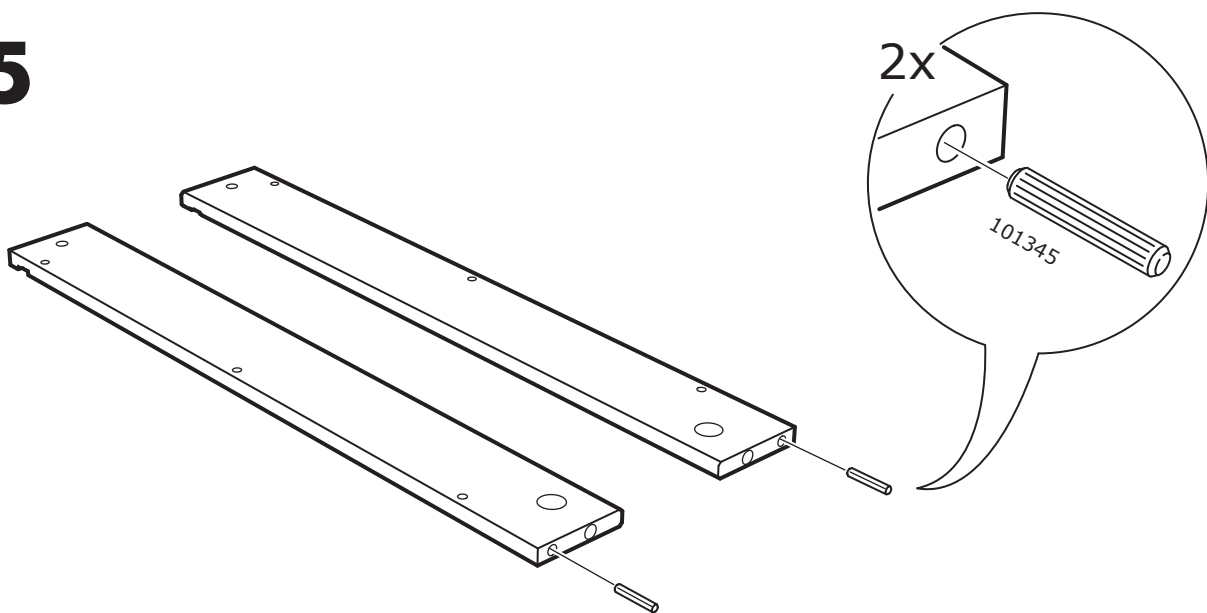

26

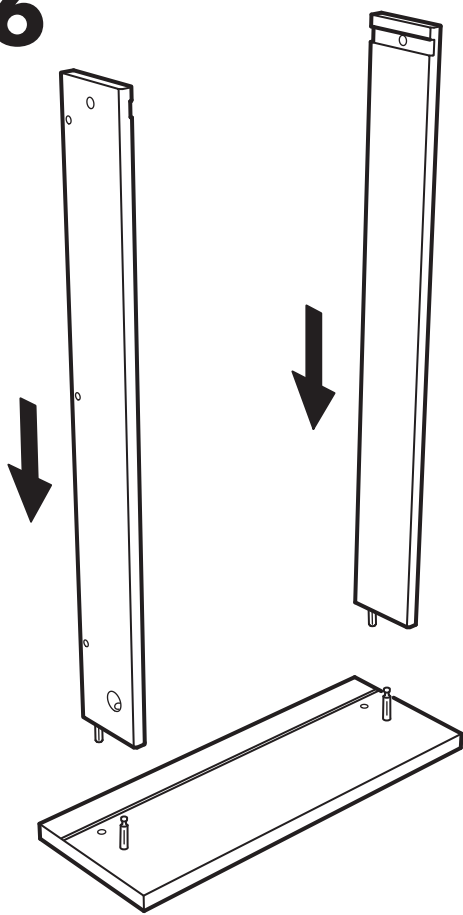

27

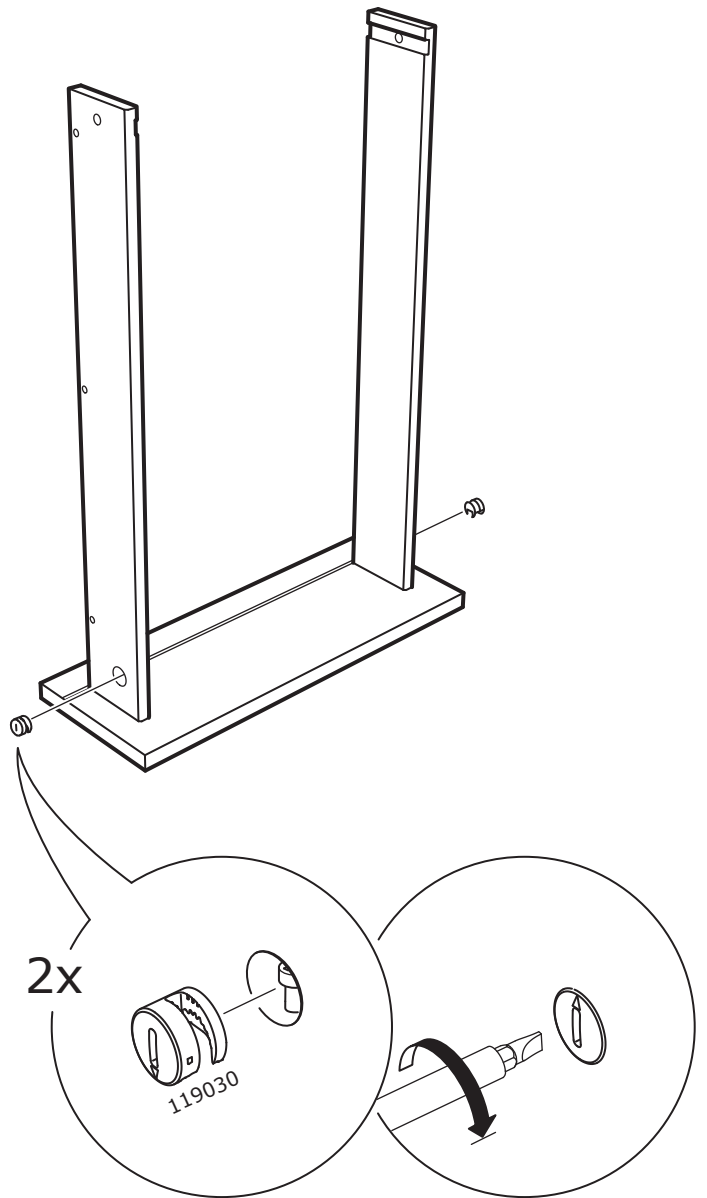

28

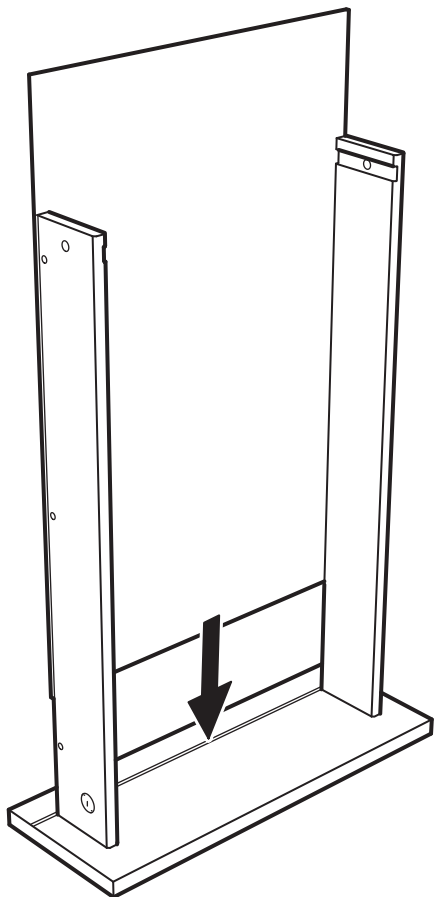

29

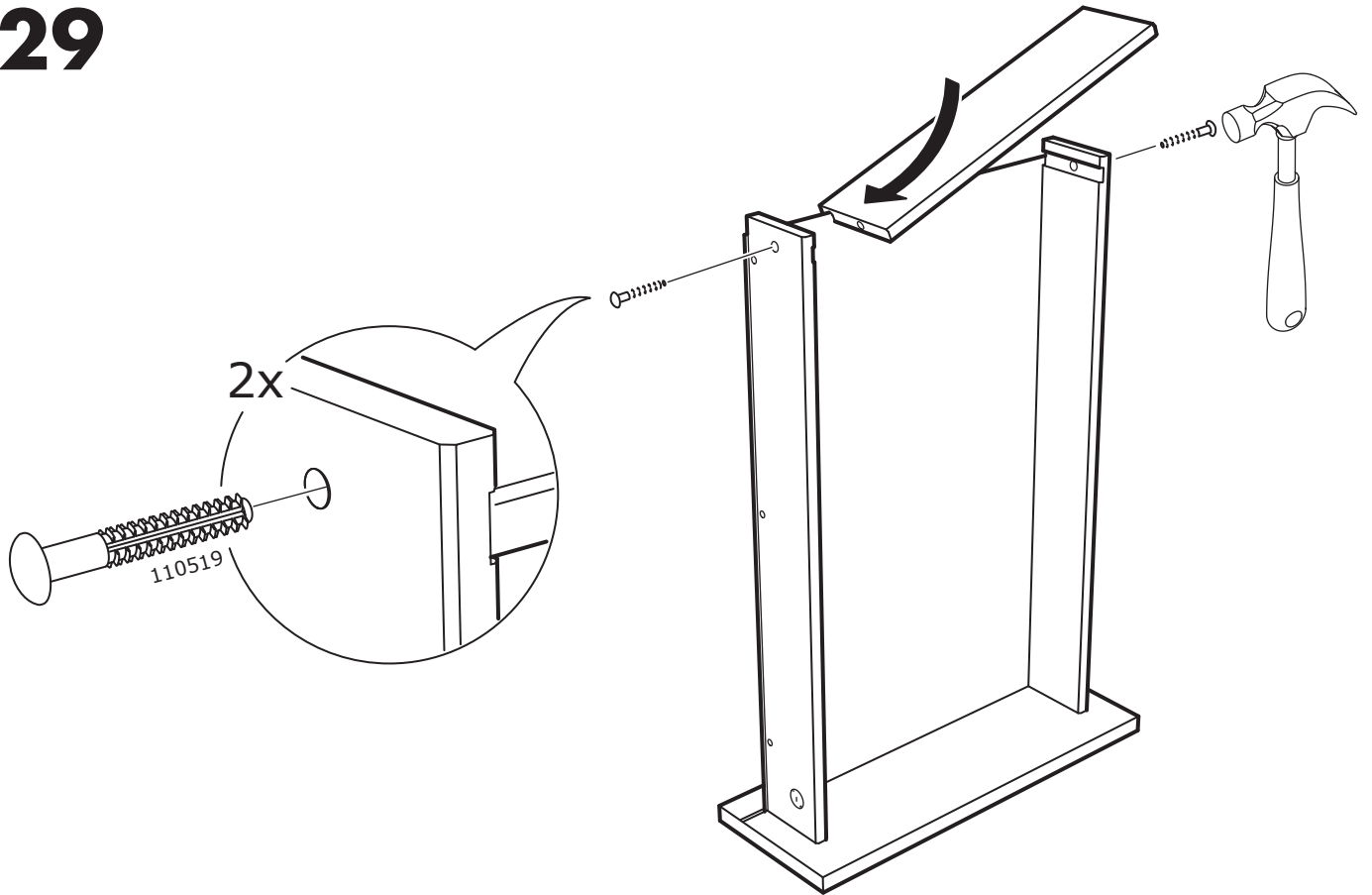

30

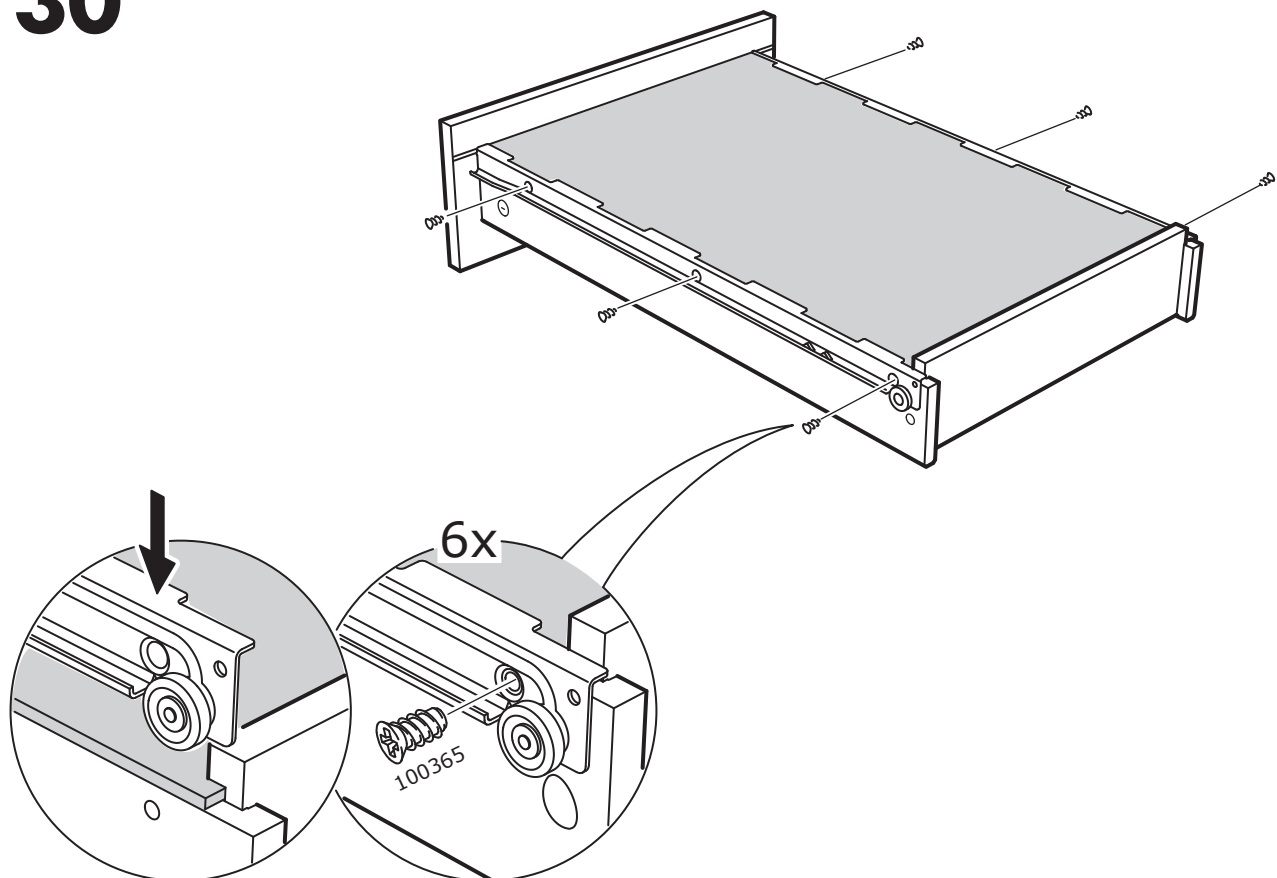

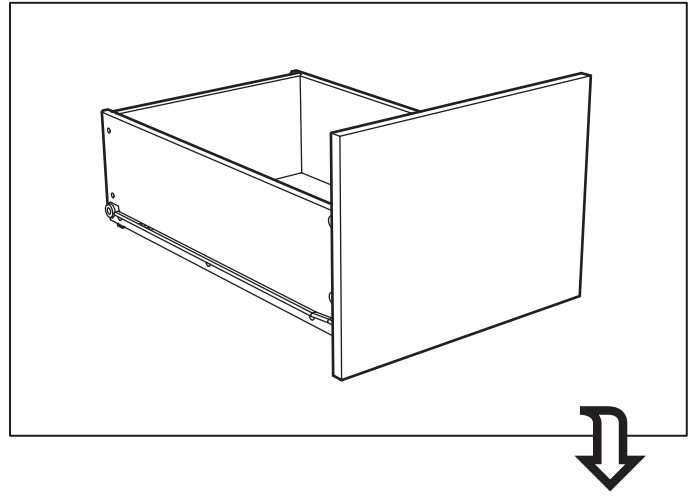

31

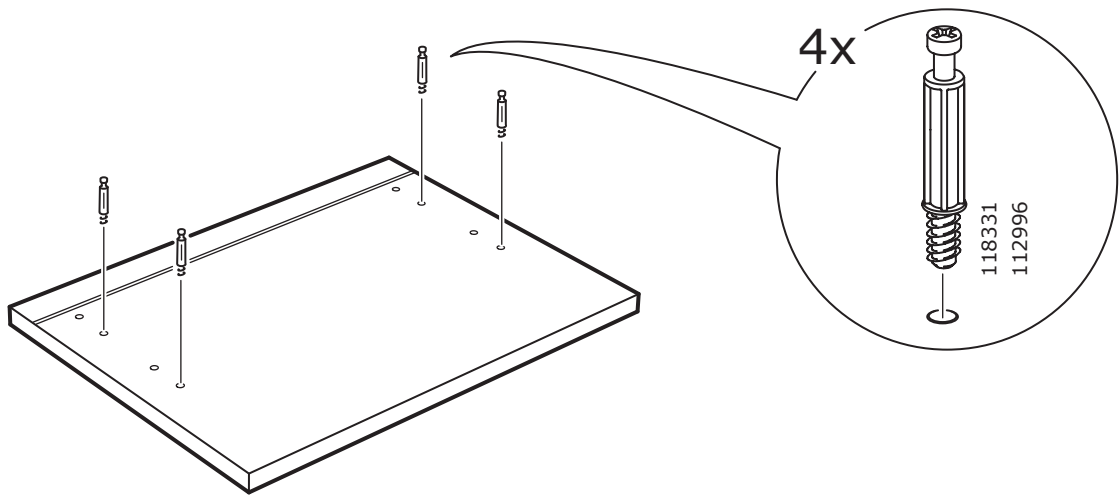

32

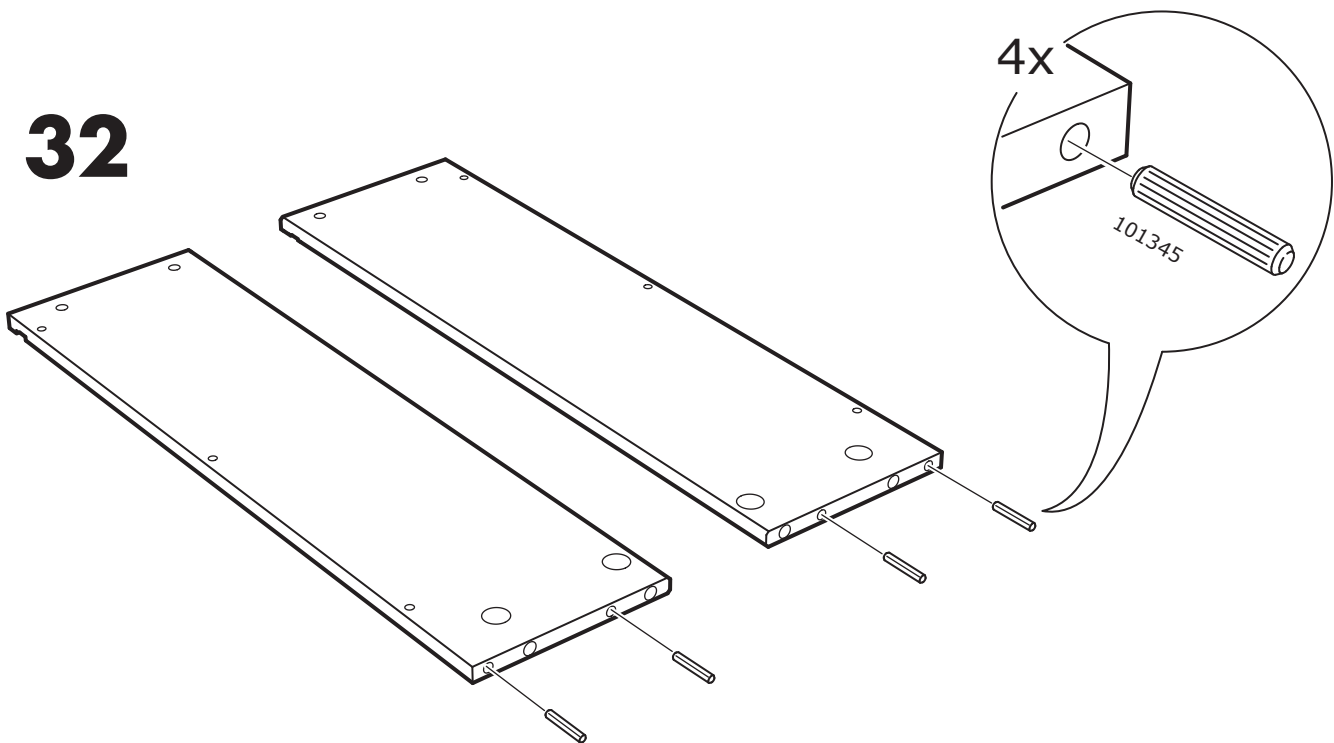

33

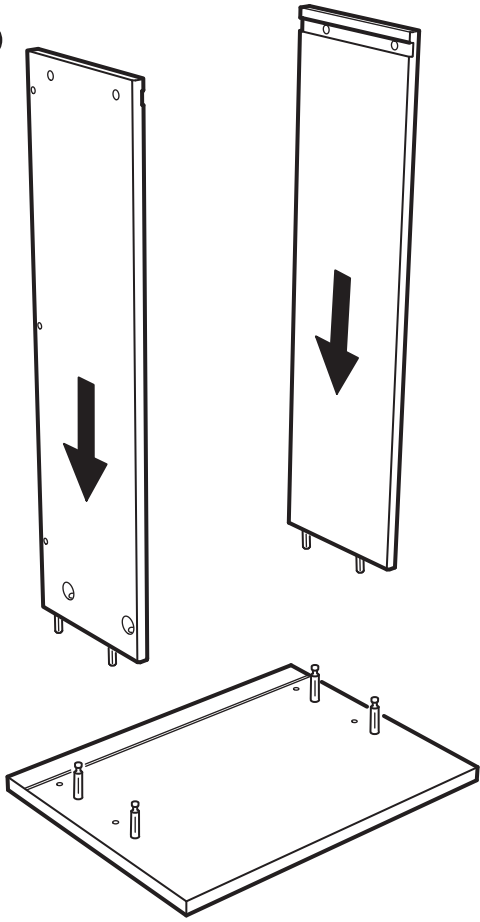

34

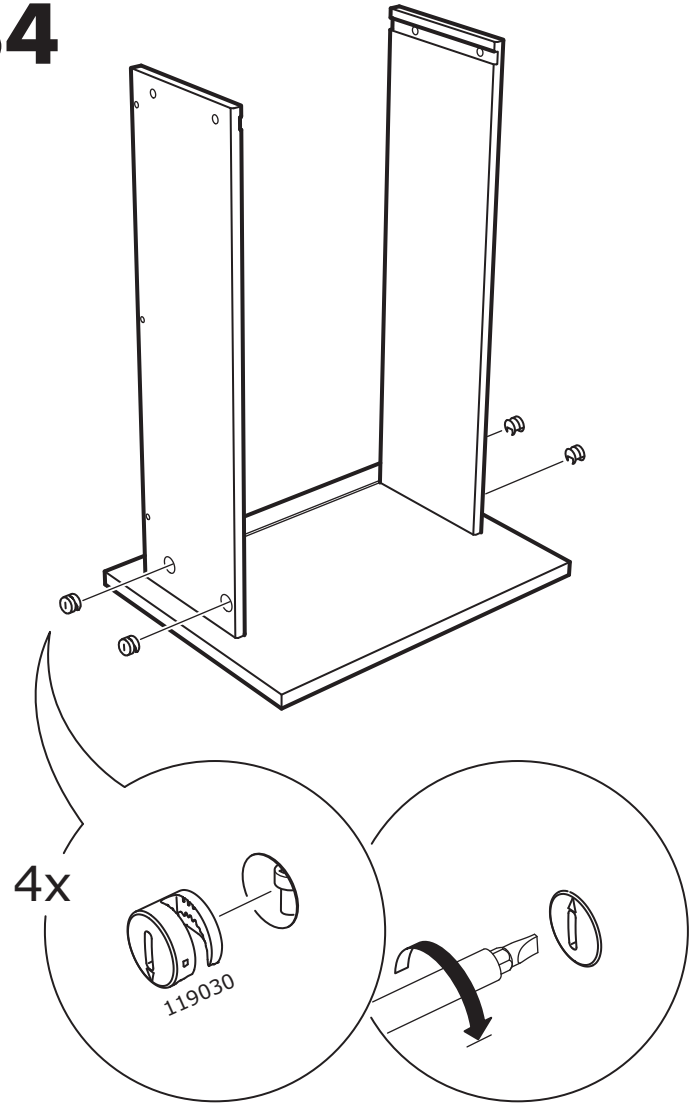

35

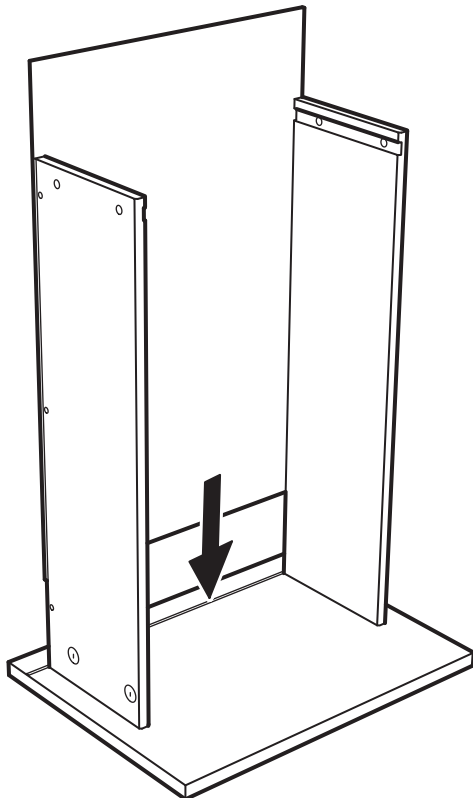

36

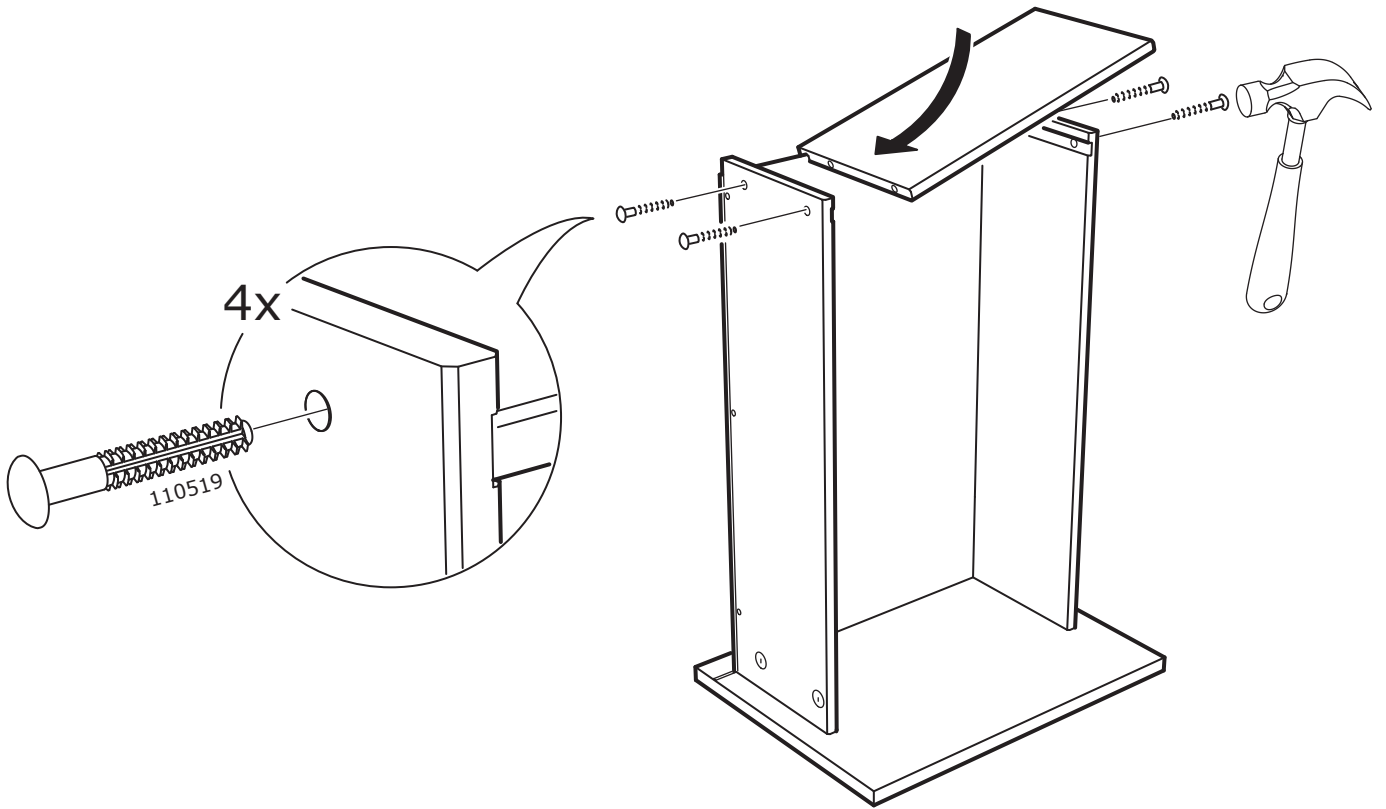

37

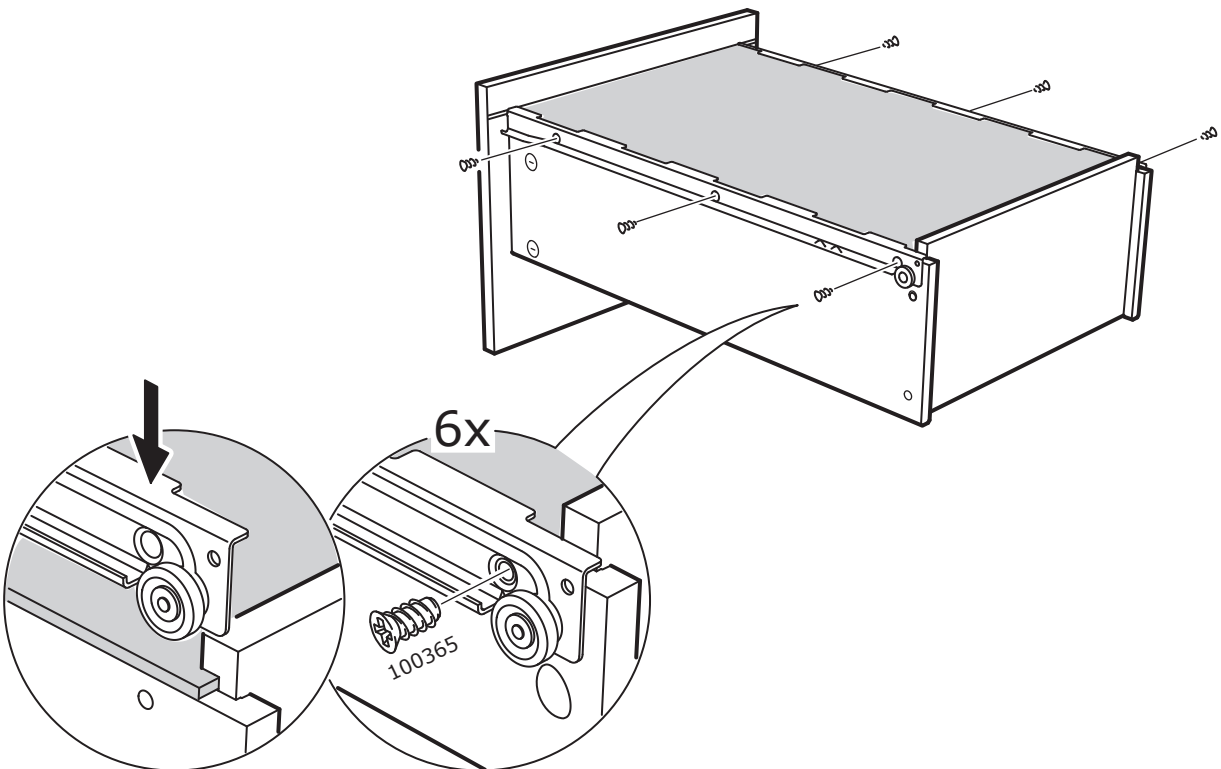

38

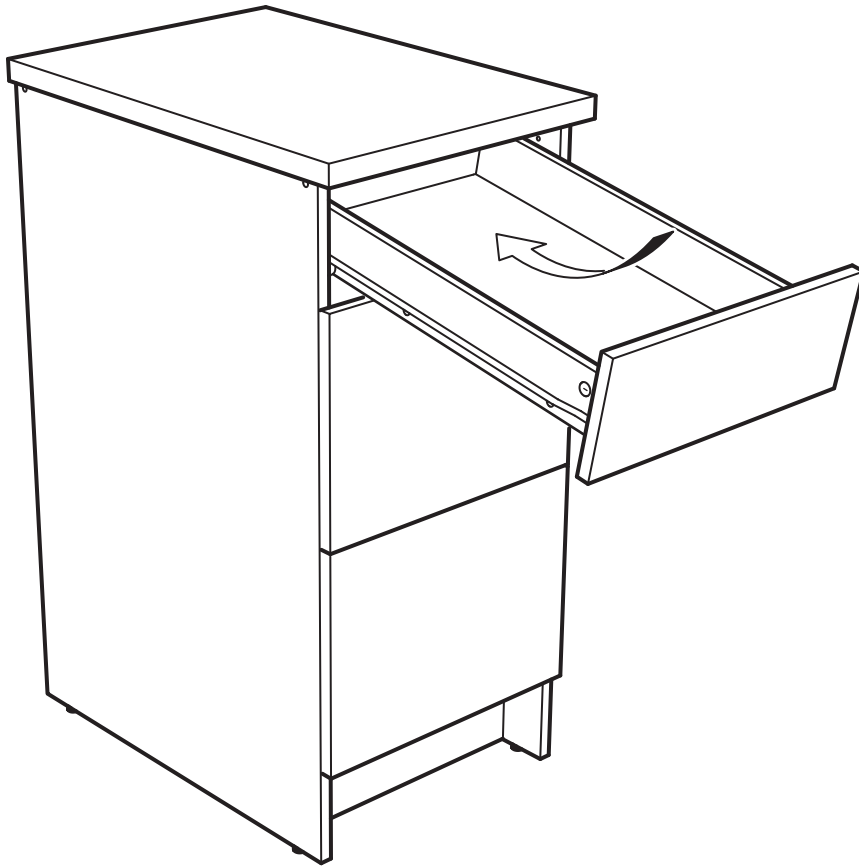

39

